

STEP 8

- REMOVE NARROW PIECE OF THE RELEASE PAPER.
- FAN DUPONT™ FLEXWRAP™ AT BOTTOM CORNERS AND ADHERE ONTO EXTERIOR FACE OF WALL. COVERAGE SHOULD BE 2"-3" ONTO THE FACE OF THE WALL.
- PRESS SILL FLASHING W/ FIRM HAND PRESSURE OR J-ROLLER TO ENSURE FULL ADHESION ON ALL SURFACES.

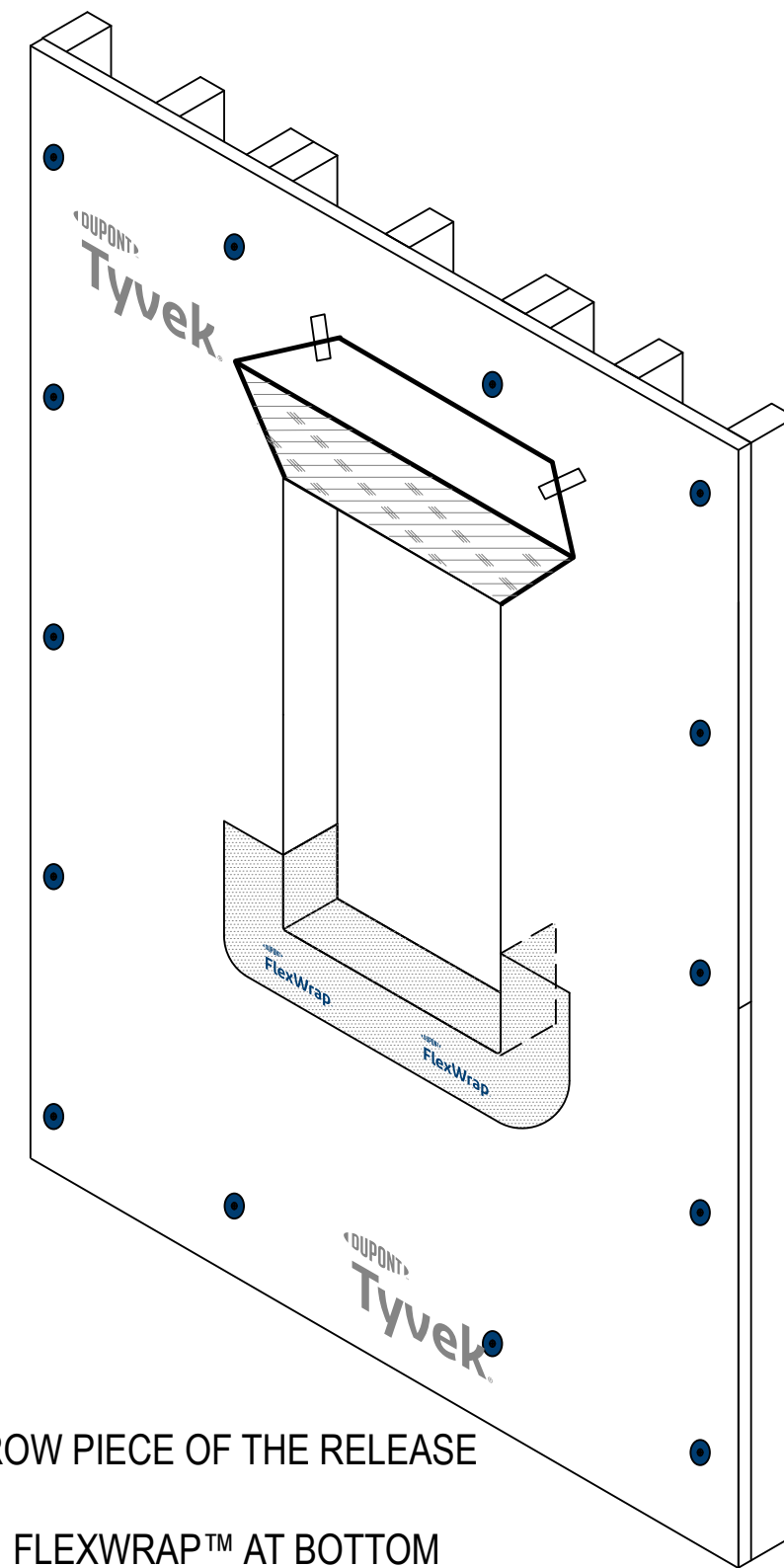

STEP 7

- REMOVE WIDE PIECE OF RELEASE PAPER. POSITION ON HORIZONTAL SILL BY ALIGNING THE INSIDE EDGE OF THE NARROW RELEASE PAPER WITH THE FACE OF THE WALL TO ENSURE 2"-3" OF THE FLEXWRAP™ WILL BE ADHERED TO THE FACE OF THE WALL WITH A MINIMUM OF 6" UP EACH JAMB.
- ADHERE INTO ROUGH OPENING. **DO NOT STRETCH** MATERIAL ALONG THE SILL OR JAMB.

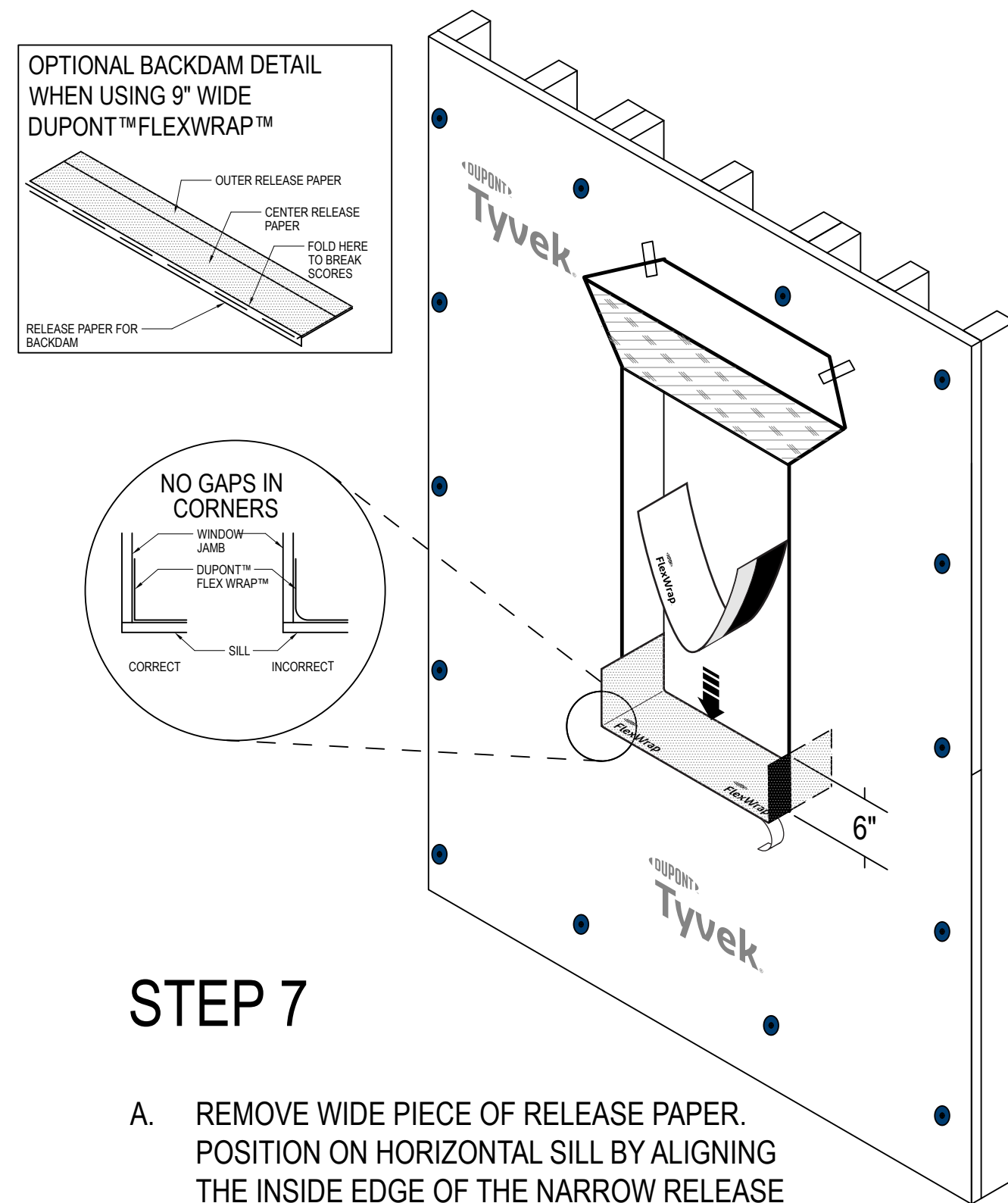

STEP 6

- PREPARE THE SILL FLASHING BY CUTTING A PIECE OF FLEXWRAP™ THAT IS AT LEAST 12" LONGER THAN THE WIDTH OF THE ROUGH OPENING SILL (S).
- USE 6" FLEXWRAP™ FOR 2"x 4" FRAMING AND 9" FLEXWRAP™ FOR 2"x 6" FRAMING.
- INSPECT INSTALLATION SURFACE TO ENSURE THE SURFACE IS FREE OF DIRT AND SUBSTANCES THAT COULD INTERFERE WITH ADHESION AS WELL AS ANY SHARP PROTRUSIONS.

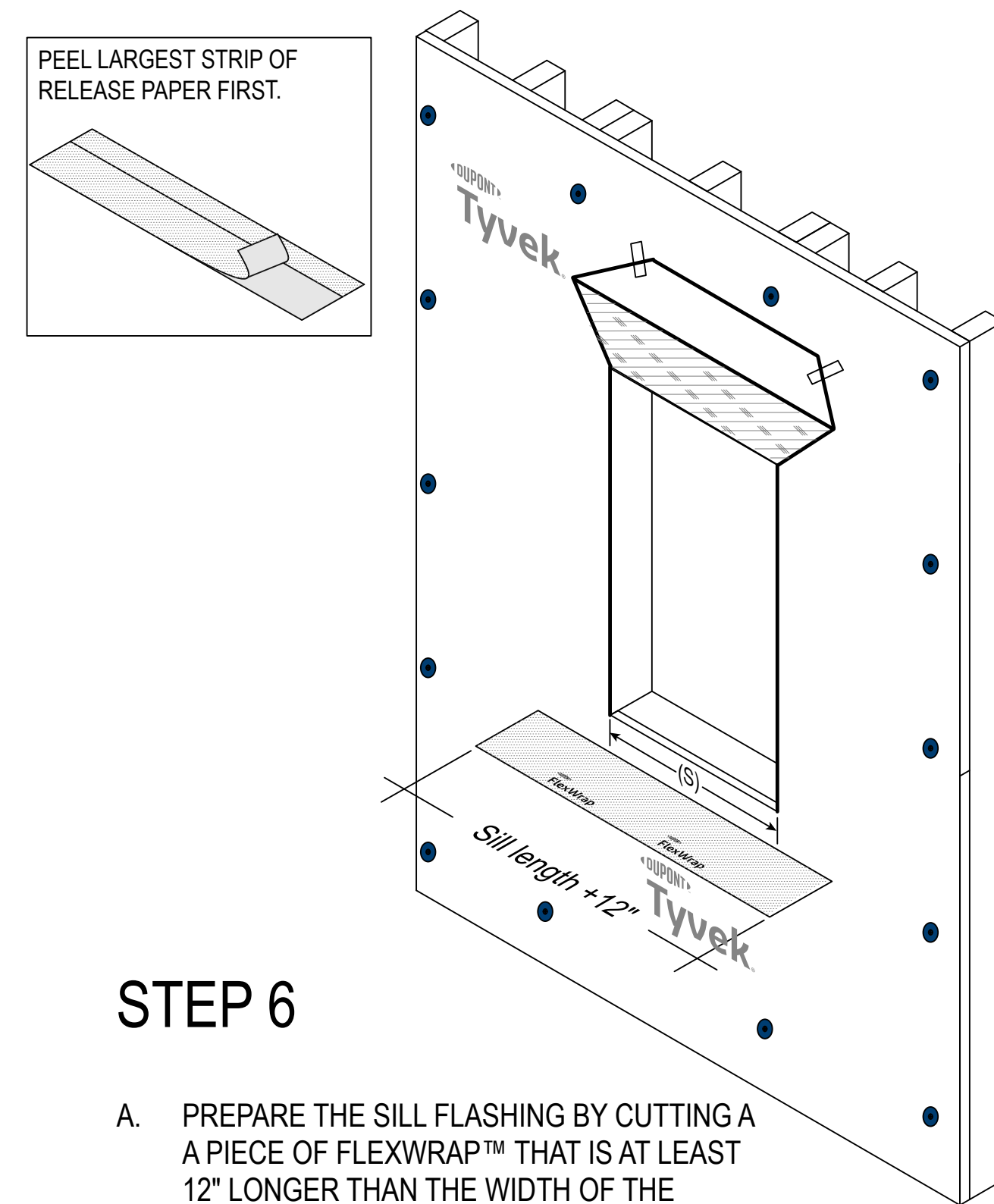

STEP 5

- FLIP HEAD FLAP UP TO EXPOSE THE SHEATHING AND TEMPORARILY SECURE WITH DUPONT™ TYVEK® TAPE.

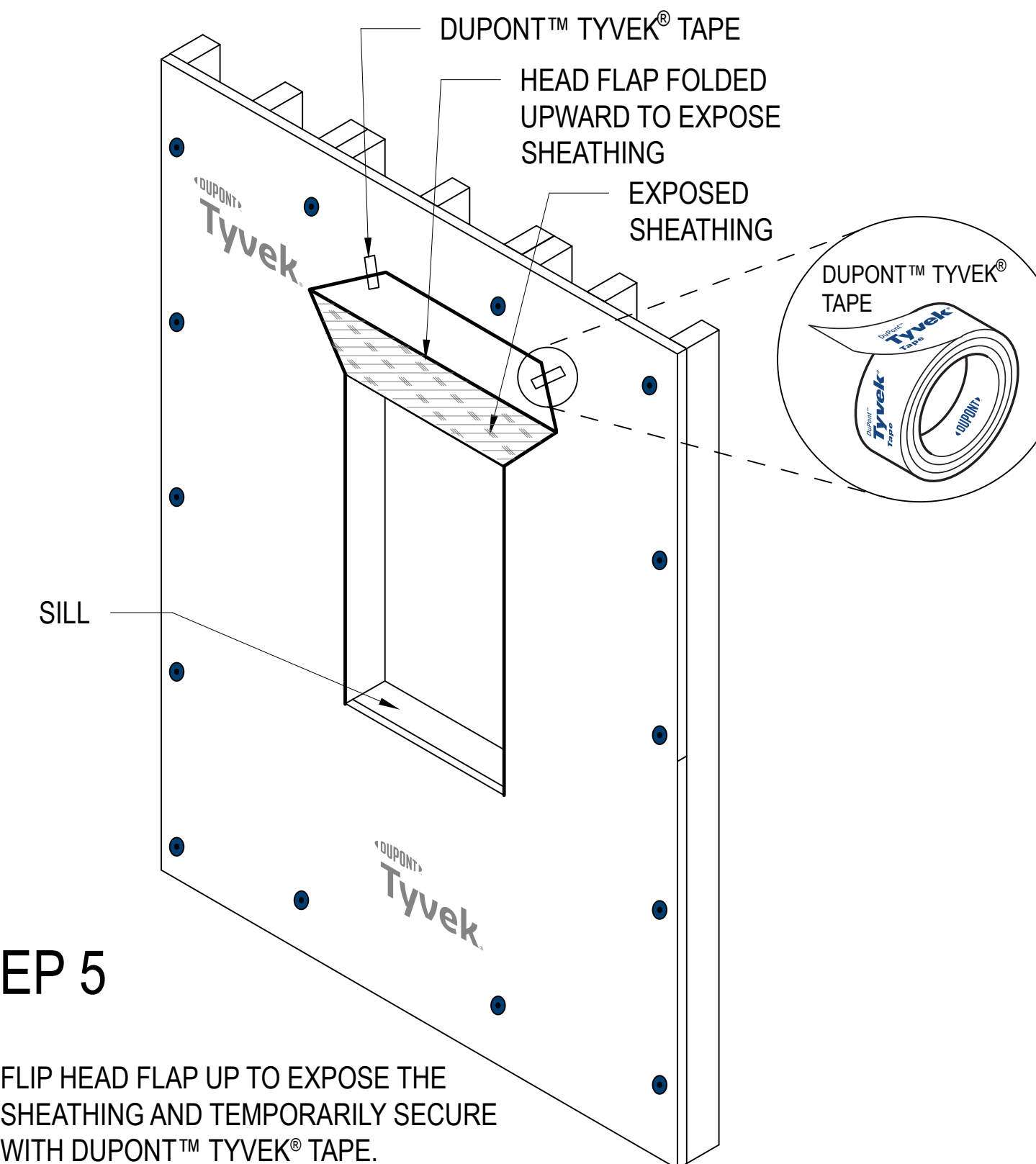

STEP 4

- FOLD SIDE FLAPS INTO ROUGH OPENING. SECURE TO INSIDE WALL, AND CUT OFF EXCESS FLAPS IF DESIRED.

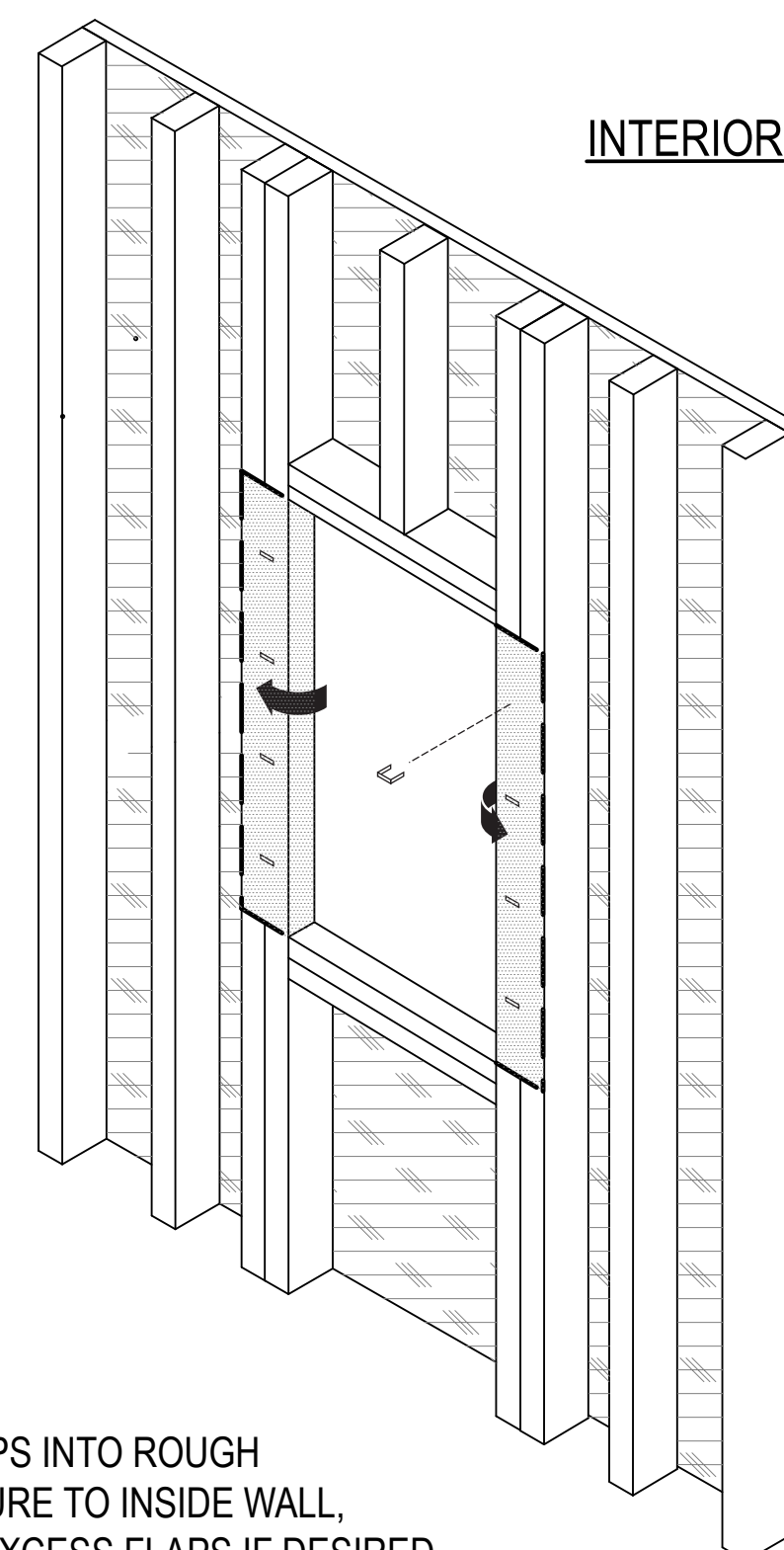

STEP 3

- CUT AN "I-CUT" IN THE TYVEK® WRB.
- CUT TWO 45 DEGREE SLITS EXTENDING A MINIMUM OF 8" FROM THE CORNERS OF THE HEAD OPENINGS TO EXPOSE SHEATHING OR FRAMING MEMBERS TO ALLOW HEAD FLASHING INSTALLATION.

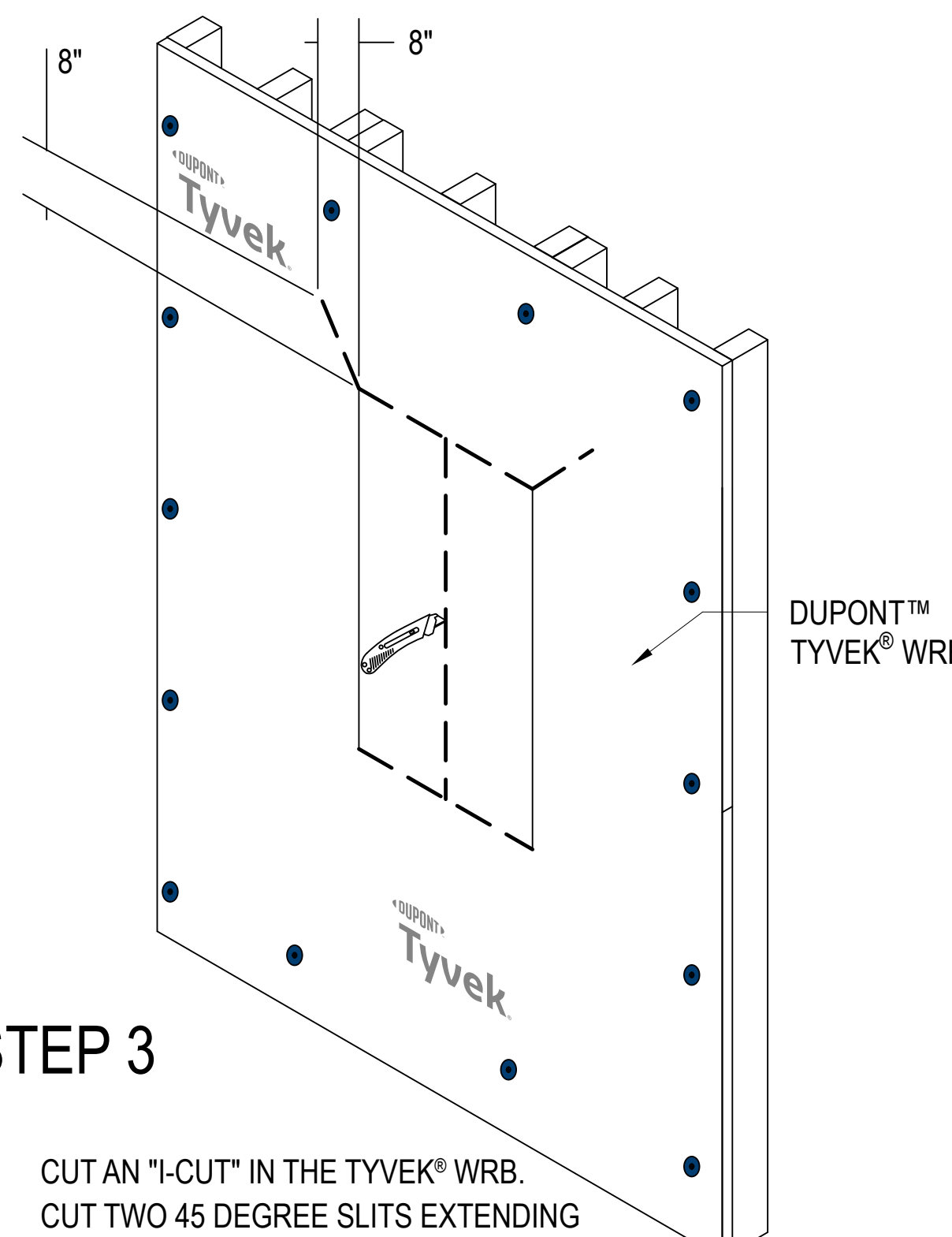

STEP 2

- DUPONT™ TYVEK® WRB TO BE MECHANICALLY FASTENED AND INSTALLED OVER SHEATHING.
- DO NOT INSTALL** FASTENERS WITHIN 6" OF THE SILLS AND JAMBS OF THE OPENINGS AND WITHIN 9" OF THE HEAD OPENINGS.

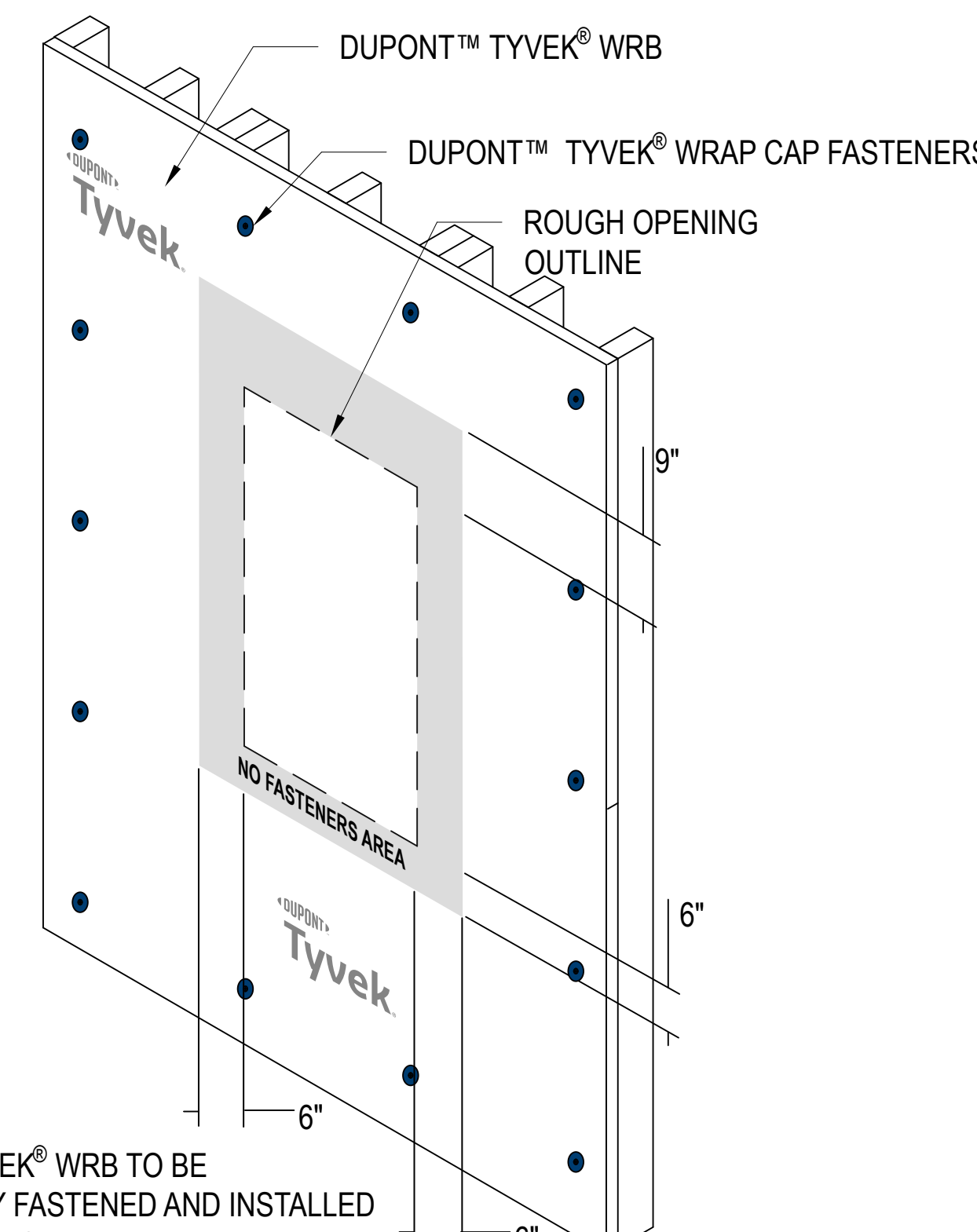

STEP 1

- SHEATHING INSTALLED OVER BARE STUDS.
- AFTER SHEATHING HAS BEEN INSTALLED, CUT AN OPENING IN THE SHEATHING ALONG THE PERIMETER OF THE ROUGH OPENING FOR WINDOW.
- ENSURE THE SHEATHING IS CUT FLUSH WITH OR SLIGHTLY BELOW THE SILL FRAMING TO ALLOW FOR POSITIVE DRAINAGE.

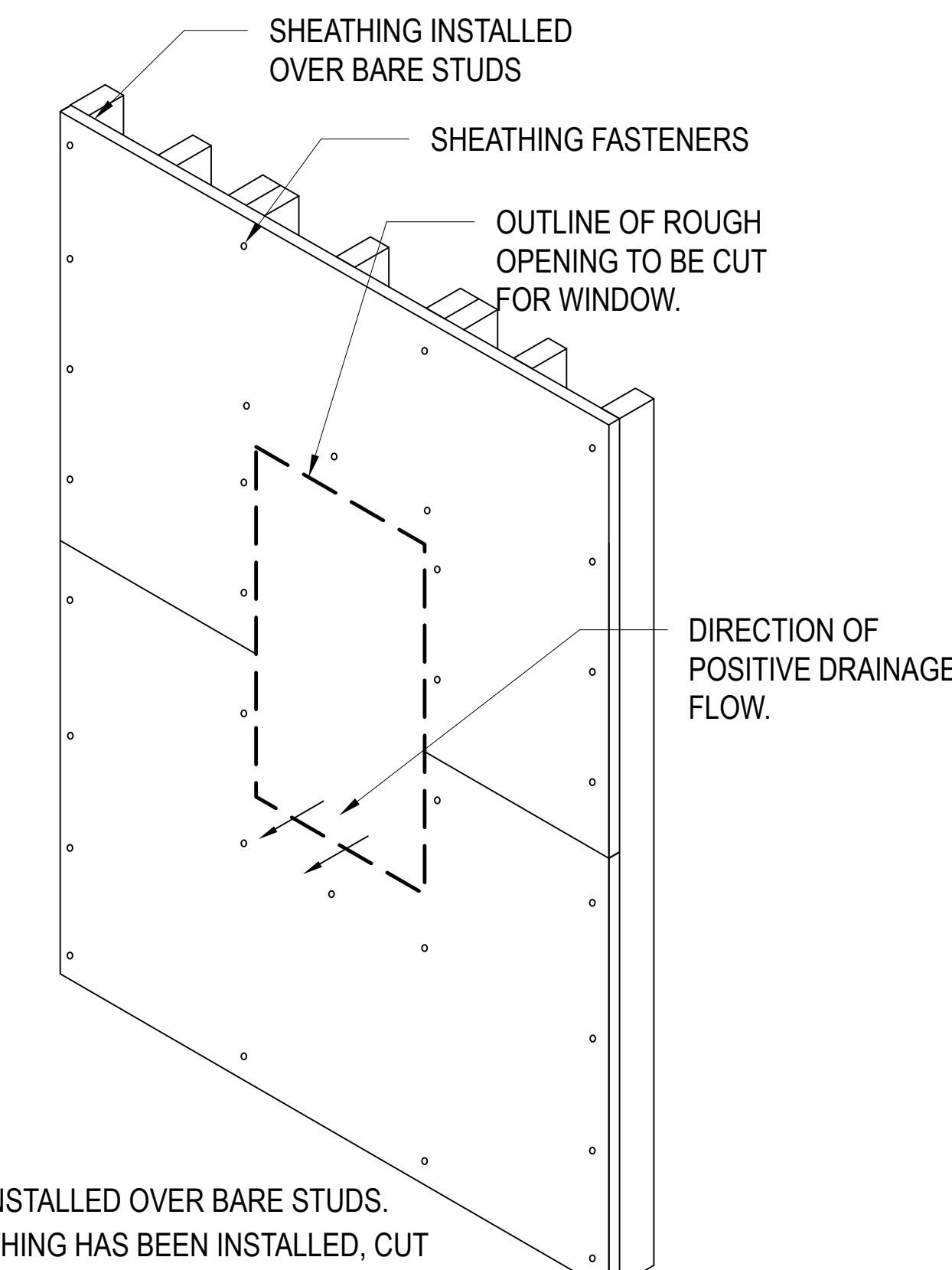

NOTES:
INSTALLATION IS APPLICABLE FOR SINGLE-FAMILY RESIDENTIAL & WOOD-FRAMED MULTI-FAMILY AND LIGHT COMMERCIAL BUILDINGS WHEN PERFORMANCE REQUIREMENTS DO NOT EXCEED ASTM E1677 (65 MPH EQUIVALENT STRUCTURAL LOAD AND 50 MPH (6.24 PSF) EQUIVALENT WIND-DRIVEN RAIN WATER INFILTRATION WHEN TESTED IN ACCORDANCE WITH ASTM E331, ASTM E1105, OR SIMILAR), AND WINDOW/DOOR DESIGN RATINGS THAT DO NOT EXCEED DP45. SEE *APPLICABLE STRUCTURES AND PERFORMANCE CRITERIA* IN THE APPLICABLE DUPONT INSTALLATION GUIDELINE FOR MORE INFORMATION REGARDING BUILDING TYPES AND BUILDING ENVELOPE PERFORMANCE. ALWAYS CHECK BUILDING.DUPONT.COM FOR THE LATEST VERSIONS OF DUPONT INSTALLATION GUIDELINES AND OTHER PRODUCT LITERATURE.

Brick Mold Windows and Doors* Using DuPont™ VersaFlange™ Installed AFTER the DuPont™ Tyvek® WRB Installation Sequence

* Must have smooth frame for proper adhesion of VersaFlange™

DRAWING:	
MF-OP-2310VF-MA	REVISION DATE
Page 1 of 3	1/20/2025
	SCALE: Not to Scale

DUPONT
Tyvek

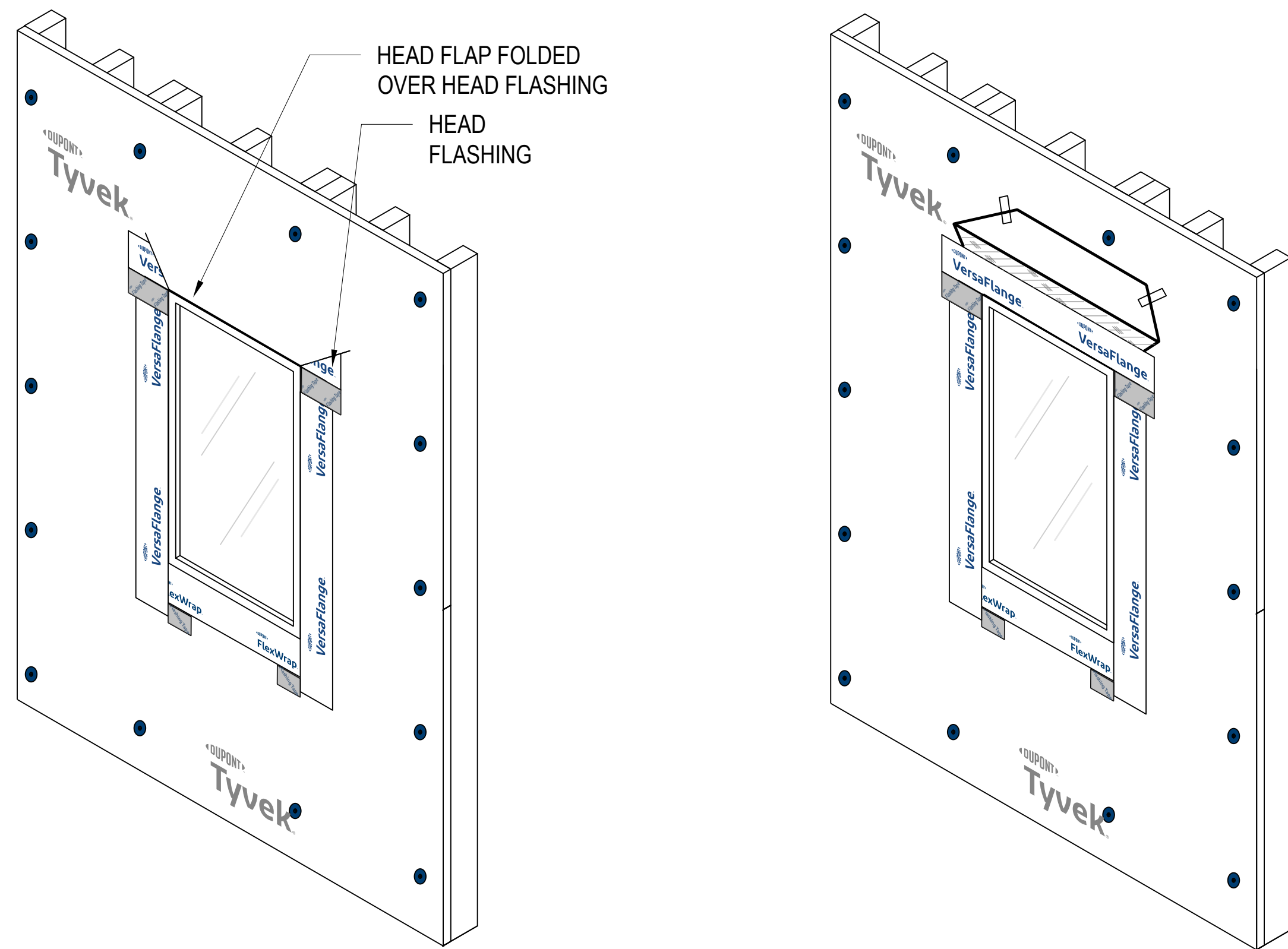

STEP 16

- A. FLIP DOWN UPPER FLAP OF TYVEK® WRB SO IT LAYS FLAT ACROSS THE HEAD FLASHING.

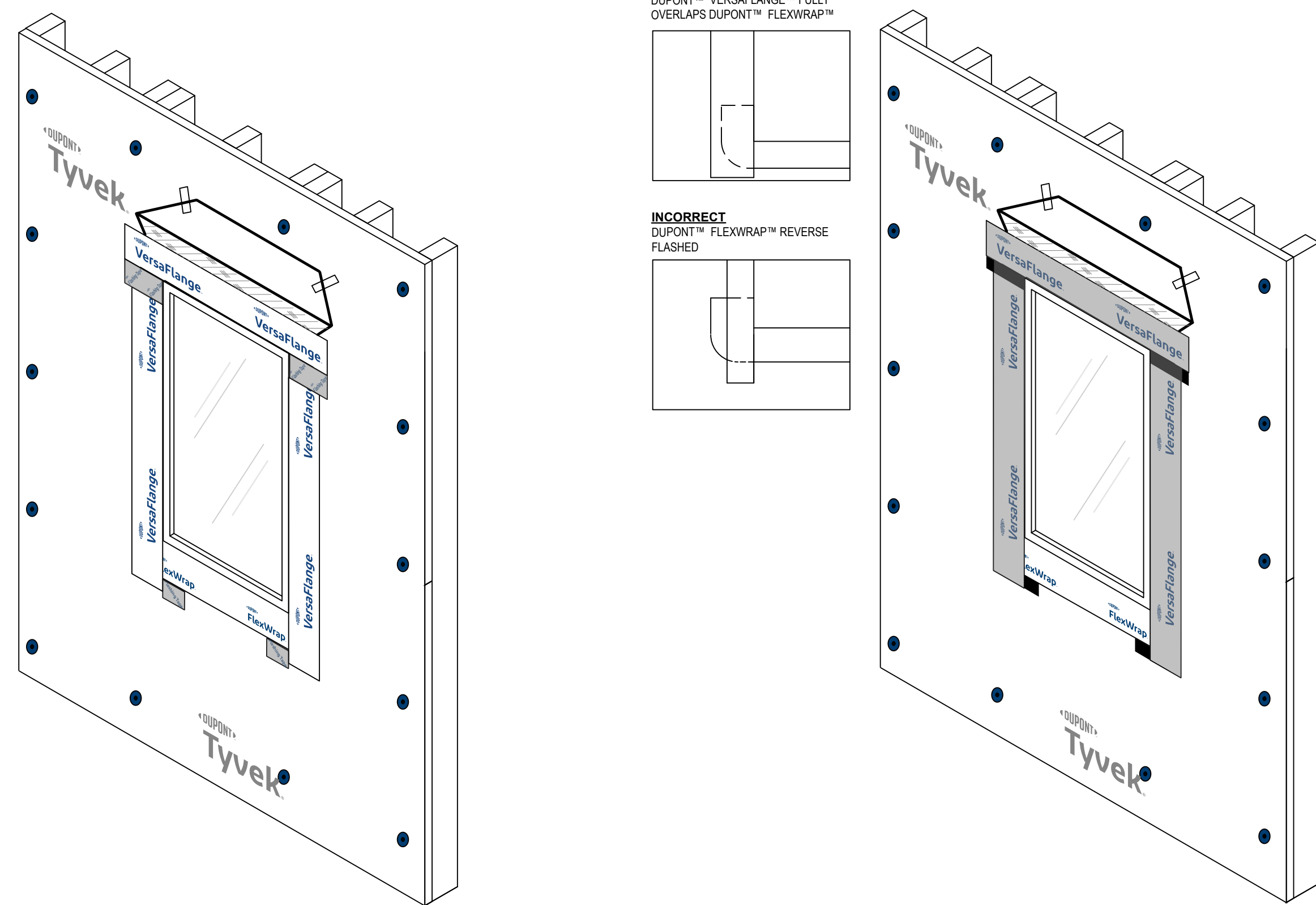

STEP 15

- A. **OPTIONAL:** COVER EXPOSED BUTYL WITH DUPONT™ FLASHING TAPE, DUPONT™ STRAIGHTFLASH™, OR DUPONT™ TYVEK® TAPE.

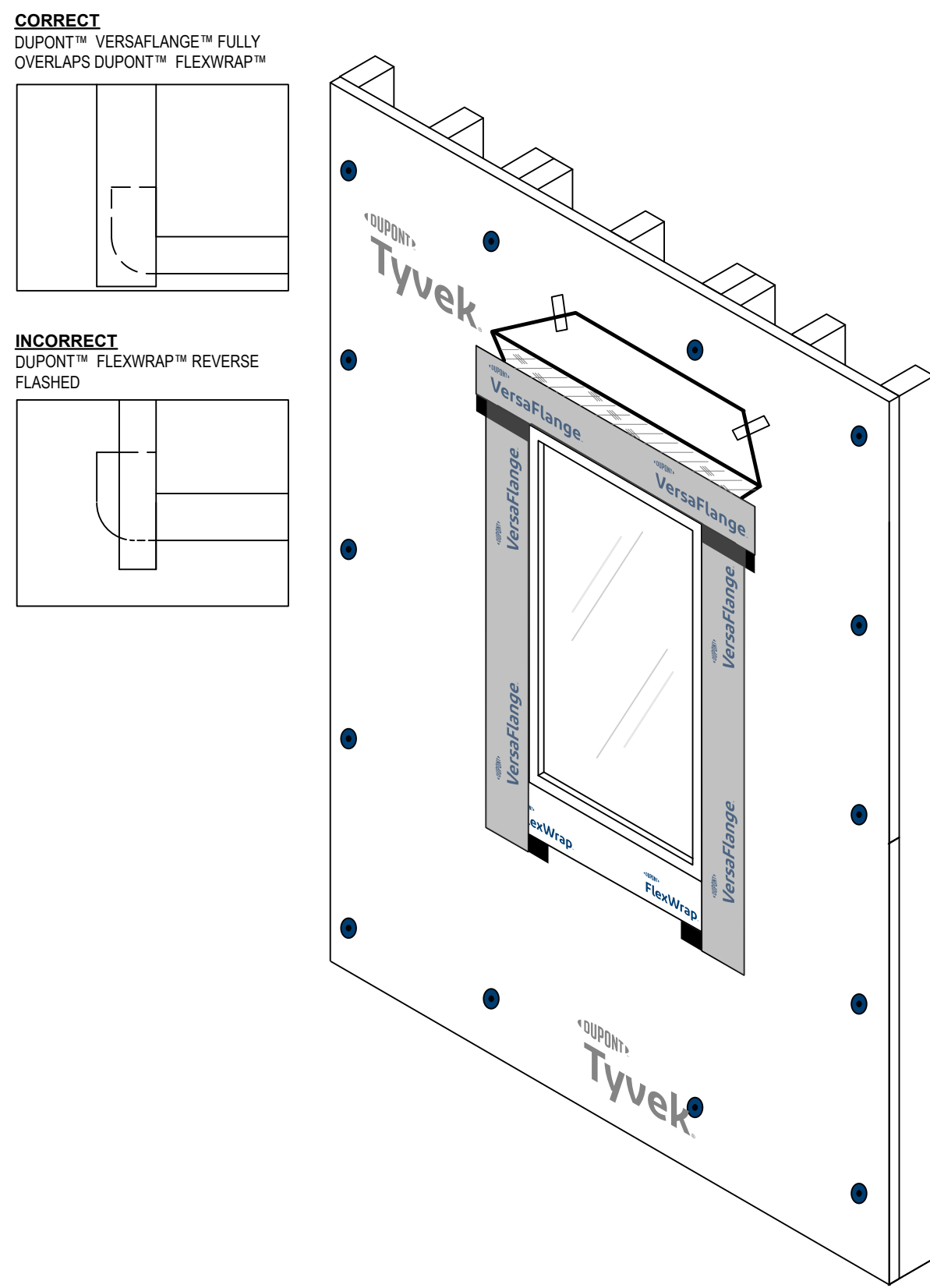

STEP 14

- A. INSTALL WINDOW ACCORDING TO MANUFACTURER'S INSTALLATION INSTRUCTIONS.
B. REMOVE THE REMAINING RELEASE PAPER FROM THE VERSAFLANGE™ JAMB FLASHING AND PRESS FIRMLY TO ADHERE TO THE TYVEK® WRB.
C. REMOVE THE RELEASE PAPER AT THE HEAD AND ADHERE IT TO THE WALL SURFACE.

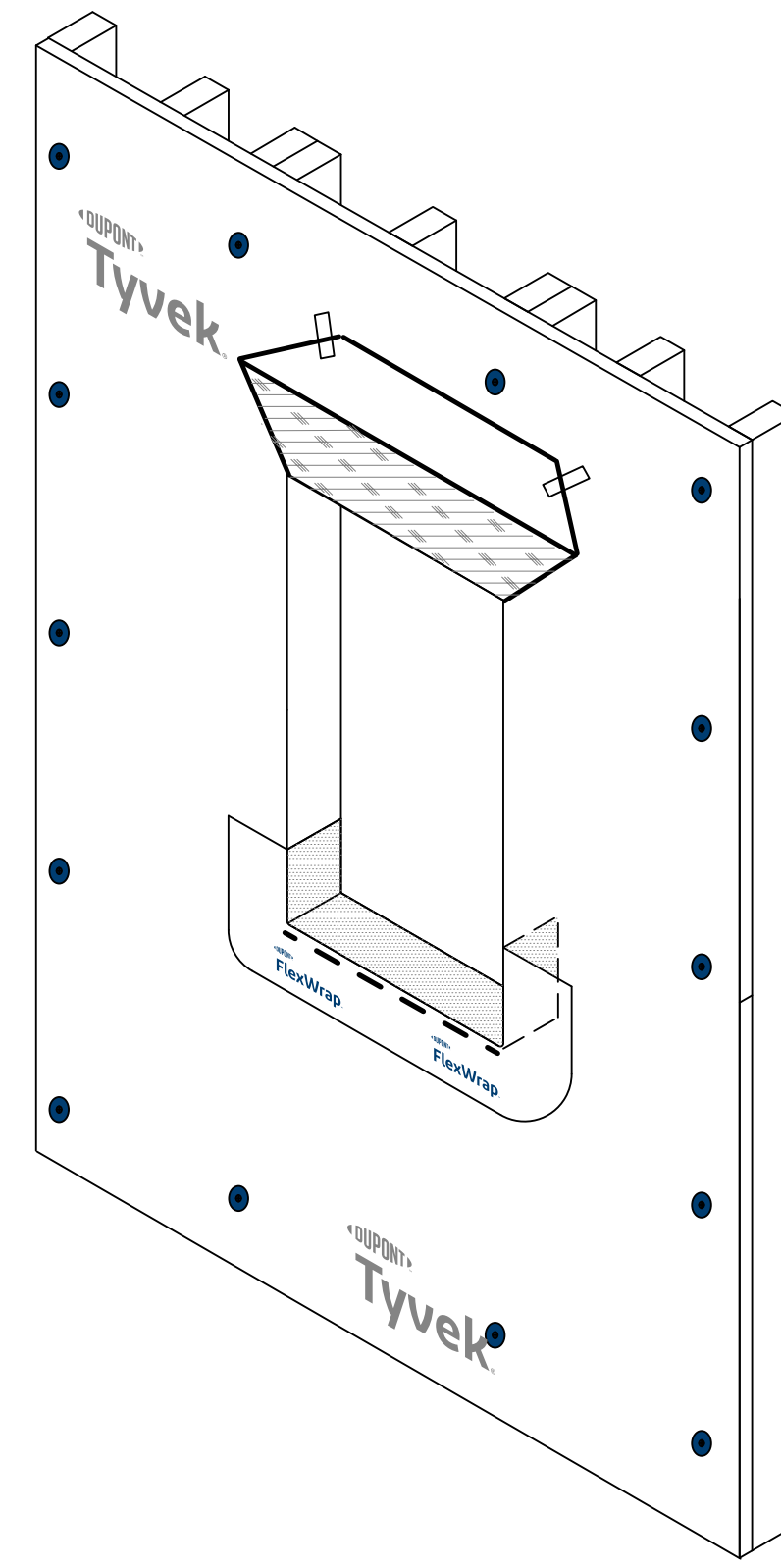

STEP 13

- A. **OPTIONAL:** APPLY A CHEMICALLY-COMPATIBLE SEALANT ALONG THE SILL AS SHOWN ABOVE. **TO ALLOW FOR DRAINAGE, DO NOT APPLY A CONTINUOUS SEALANT BEAD ALONG SILL.** ENSURE A MINIMUM 2" WIDE DRAINAGE GAP IN THE SEALANT BEAD WITHIN 4" FROM EACH CORNER OF JAMB-SILL INTERFACE. APPLY WITH ADDITIONAL 2" WIDE (MIN.) GAPS FOR EVERY 6"-12" (ON CENTER) OF SILL WIDTH.

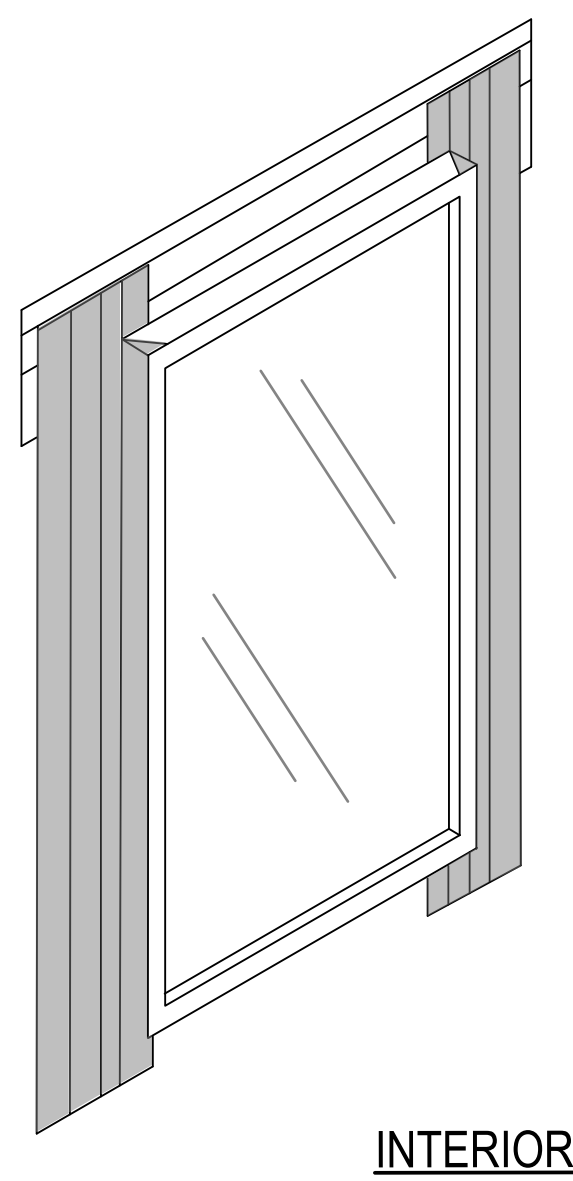

STEP 12

- A. BEGINNING AT THE JUNCTION OF THE JAMB AND HEAD, CUT THE VERSAFLANGE™ ALONG THE CORNERS AT A 45 DEGREE ANGLE AND FOLD IT OVER FLAT TO ADHERE IT AGAINST THE HEAD FLASHING.
B. FOLD NEWLY CREATED FLAP PARALLEL TO THE WINDOW FRAME.
C. FOLD FLASHING FLAPS TO THE WINDOW FRAME AND ADHERE.
D. REPEAT ON OPPOSITE JAMB.

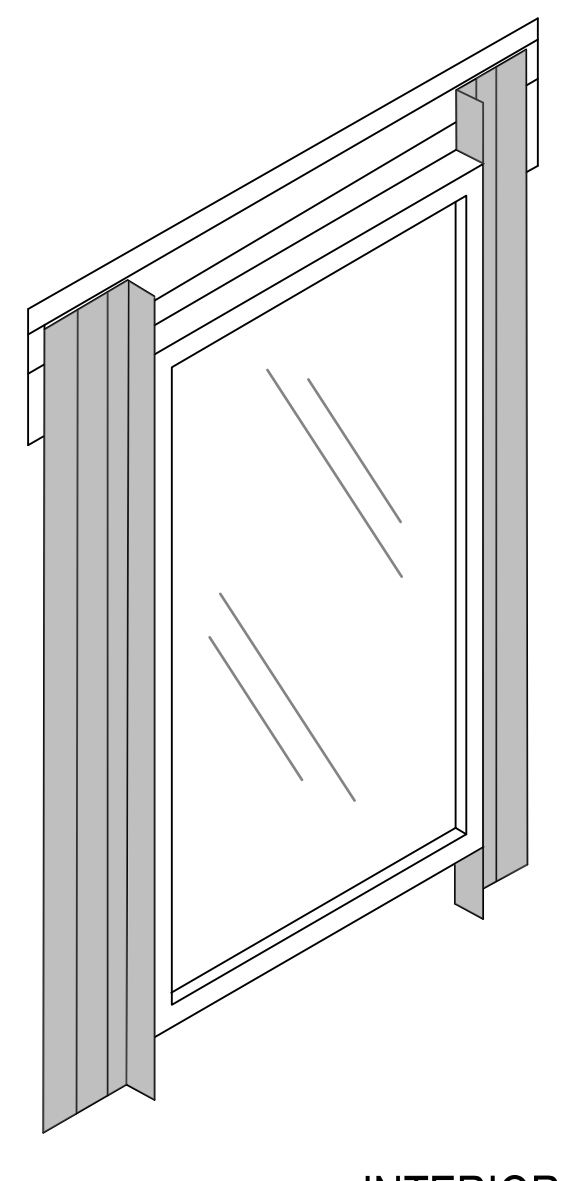

STEP 11

- A. POSITION THE VERSAFLANGE™ SO THAT IT CONTACTS THE WINDOW FRAME UP TO THE EXTERIOR FACE OF THE WINDOW. ENSURE THAT THE JAMB FLASHING IS POSITIONED 1-1/2" BELOW TOP OF THE HEAD FLASHING. THE JAMB FLASHING ADHESIVE MUST COME INTO CONTACT WITH HEAD FLASHING ADHESIVE AND OVERLAP BY 1".
B. REPEAT ON OPPOSITE JAMB.

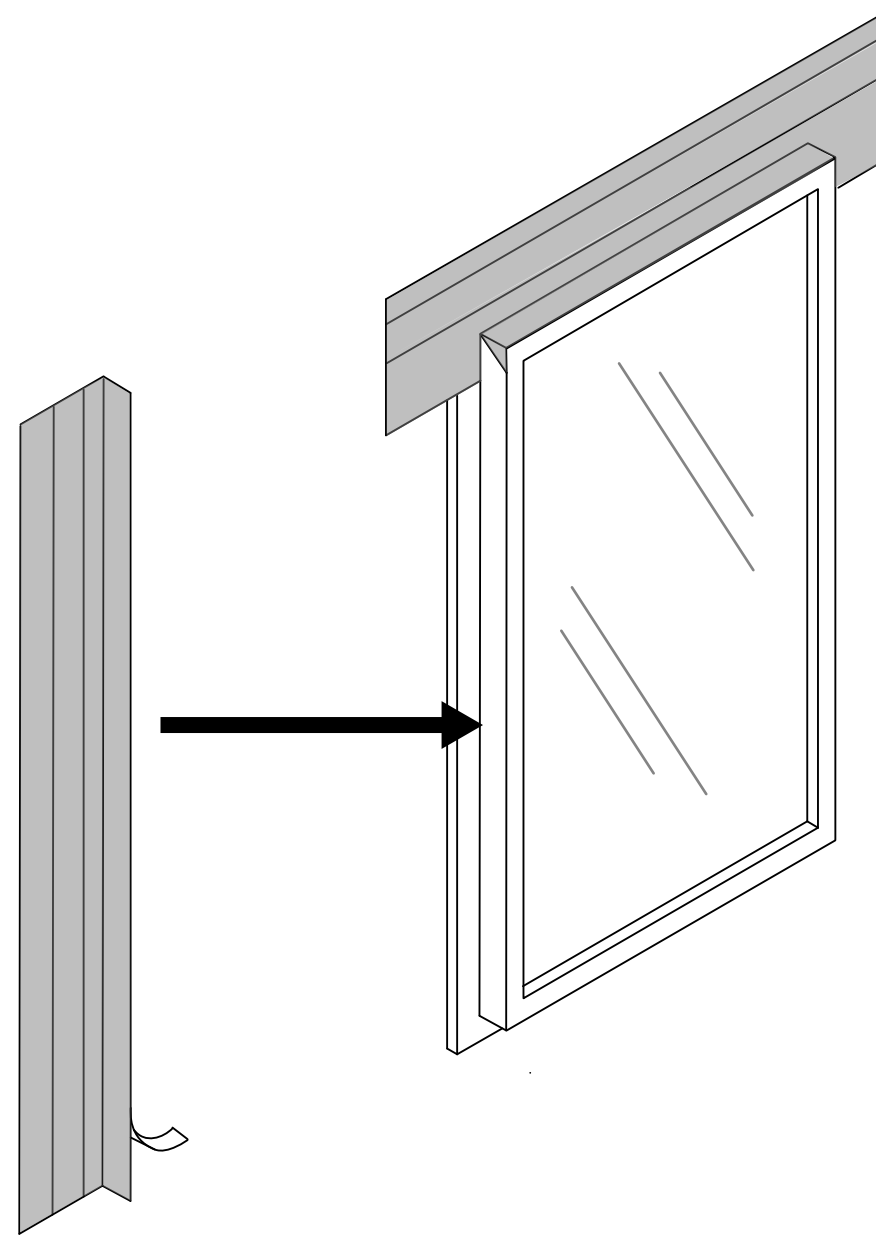

STEP 10

- A. PREPARE JAMB FLASHING BY CUTTING A PIECE OF VERSAFLANGE™ AT LEAST 6" LONGER THAN JAMB HEIGHT.
B. REMOVE THE RELEASE PAPER FROM ONE SIDE OF VERSAFLANGE™.

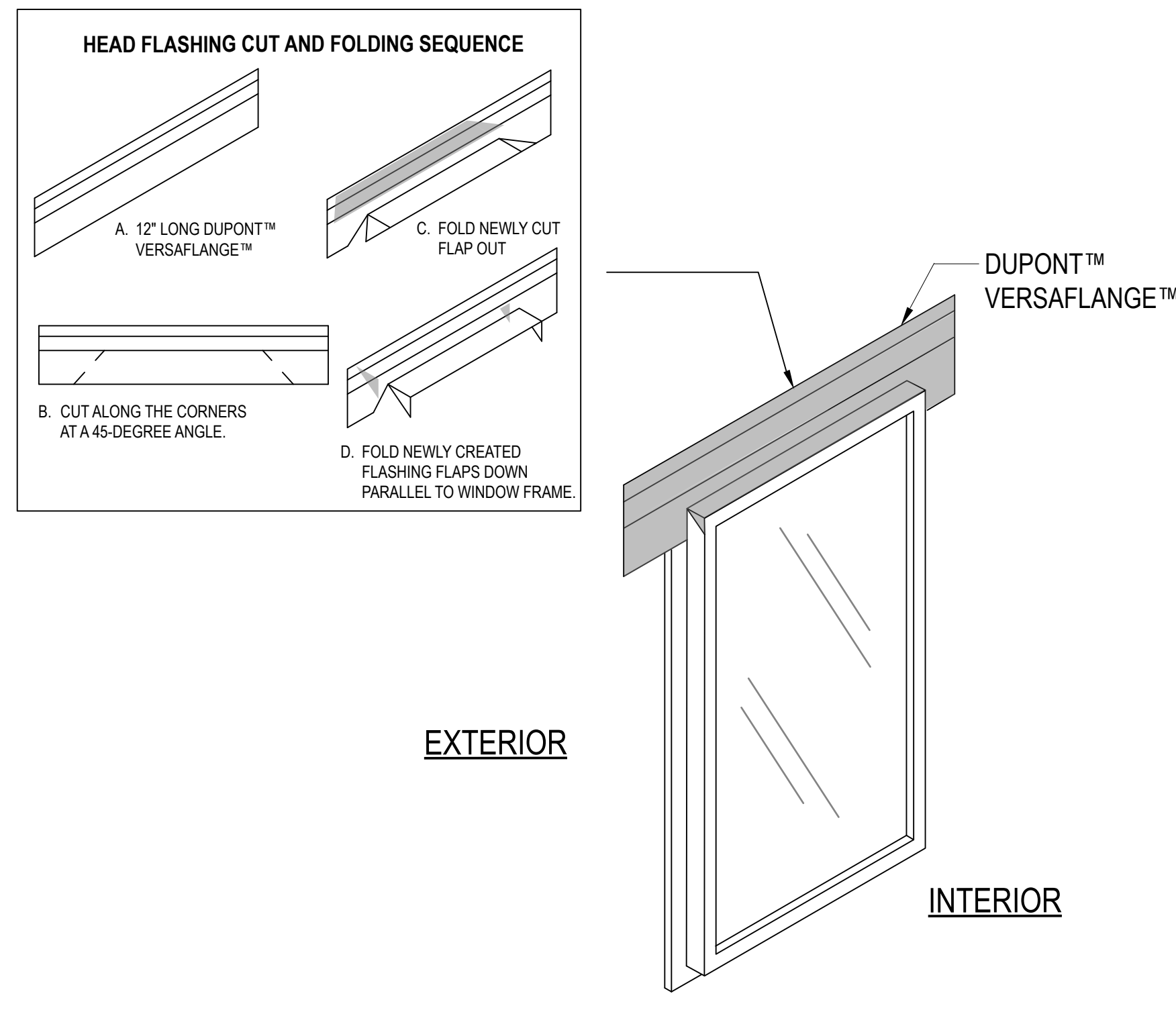

STEP 9

- A. PREPARE HEAD FLASHING BY CUTTING A PIECE OF DUPONT™ VERSAFLANGE™ AT LEAST 12" LONGER THAN THE HEAD LENGTH.
B. REMOVE THE RELEASE PAPER FROM ONE SIDE OF VERSAFLANGE™.
C. CENTER THE VERSAFLANGE™ ALONG THE LENGTH OF THE WINDOW AND POSITION IT SO IT CONTACTS THE WINDOW FRAME.
D. BEGINNING AT THE JUNCTION OF THE JAMB AND HEAD, AWAY FROM THE CORNERS, CUT THE VERSAFLANGE™ ALONG THE CORNER AT A 45 DEGREE ANGLE.
E. FOLD THE NEWLY CREATED FLASHING FLAPS DOWN, PARALLEL TO THE WINDOW FRAME.
F. FOLD THE REMAINING HEAD FLASHING ONTO THE JAMB.

NOTES:
INSTALLATION IS APPLICABLE FOR SINGLE-FAMILY RESIDENTIAL & WOOD-FRAMED MULTI-FAMILY AND LIGHT COMMERCIAL BUILDINGS WHEN PERFORMANCE REQUIREMENTS DO NOT EXCEED ASTM E1677 (65 MPH EQUIVALENT STRUCTURAL LOAD AND 50 MPH (6.24 PSF) EQUIVALENT WIND-DRIVEN RAIN WATER INFILTRATION WHEN TESTED IN ACCORDANCE WITH ASTM E331, ASTM E1105, OR SIMILAR), AND WINDOW/DOOR DESIGN RATINGS THAT DO NOT EXCEED DP45. SEE *APPLICABLE STRUCTURES AND PERFORMANCE CRITERIA* IN THE APPLICABLE DUPONT INSTALLATION GUIDELINE FOR MORE INFORMATION REGARDING BUILDING TYPES AND BUILDING ENVELOPE PERFORMANCE.
ALWAYS CHECK BUILDING.DUPONT.COM FOR THE LATEST VERSIONS OF DUPONT INSTALLATION GUIDELINES AND OTHER PRODUCT LITERATURE.

Brick Mold Windows and Doors* Using DuPont™ VersaFlange™ Installed AFTER the DuPont™ Tyvek® WRB Installation Sequence

* Must have smooth frame for proper adhesion of VersaFlange™

DRAWING: MF-OP-2310VF-MA Page 2 of 3	REVISION DATE 1/20/2025 SCALE: Not to Scale
---------------------------------------------------	---------------------------------------------------

DUPONT
Tyvek

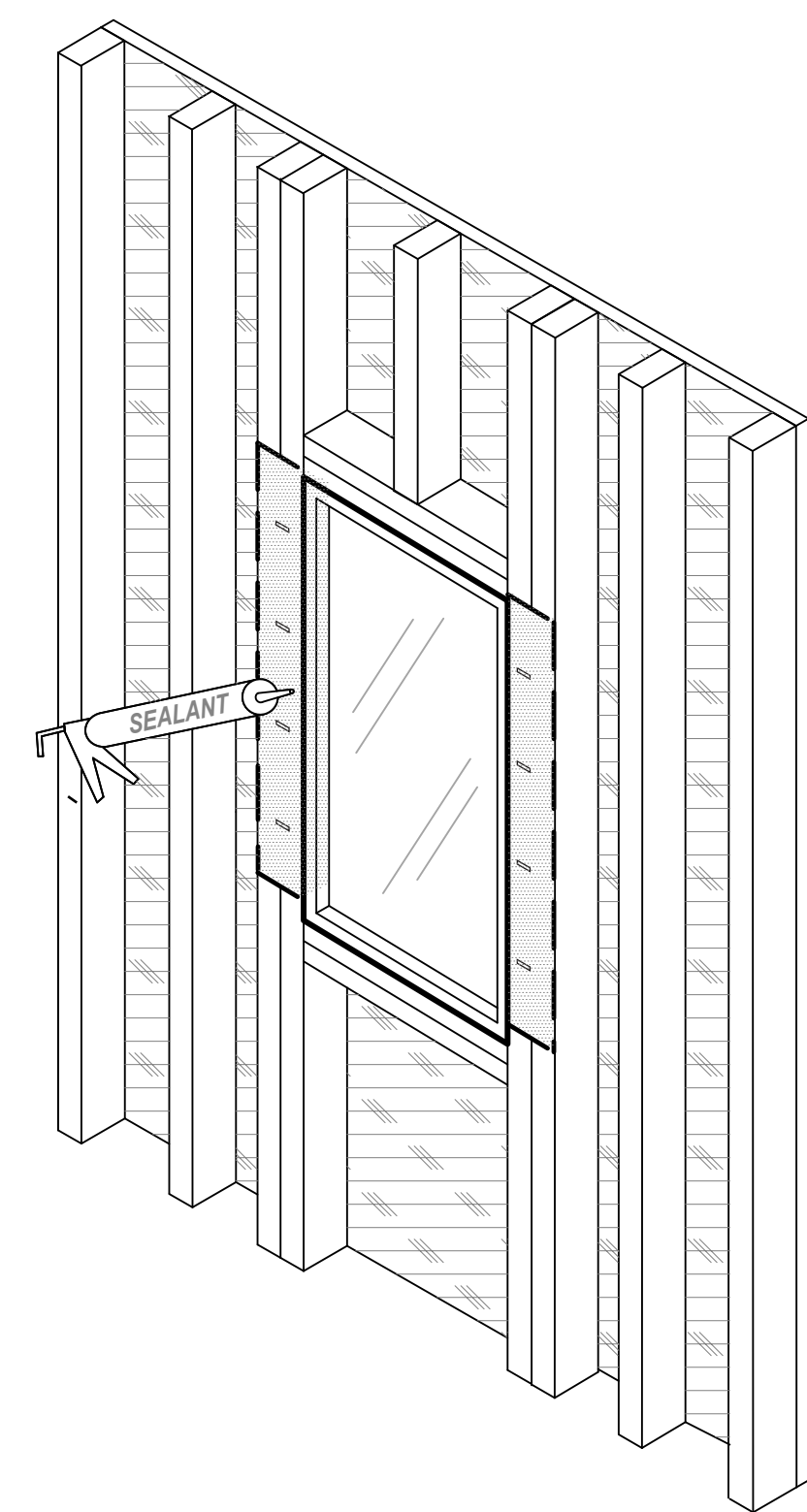

STEP 19

- A. APPLY A CHEMICALLY-COMPATIBLE SEALANT (AND BACKER ROD AS NECESSARY) AROUND THE WINDOW OPENING AT THE INTERIOR. IT IS ALSO ACCEPTABLE TO USE GREAT STUFF PRO™ WINDOW AND DOOR POLYURETHANE FOAM SEALANT, OR A CHEMICALLY-COMPATIBLE FOAM.

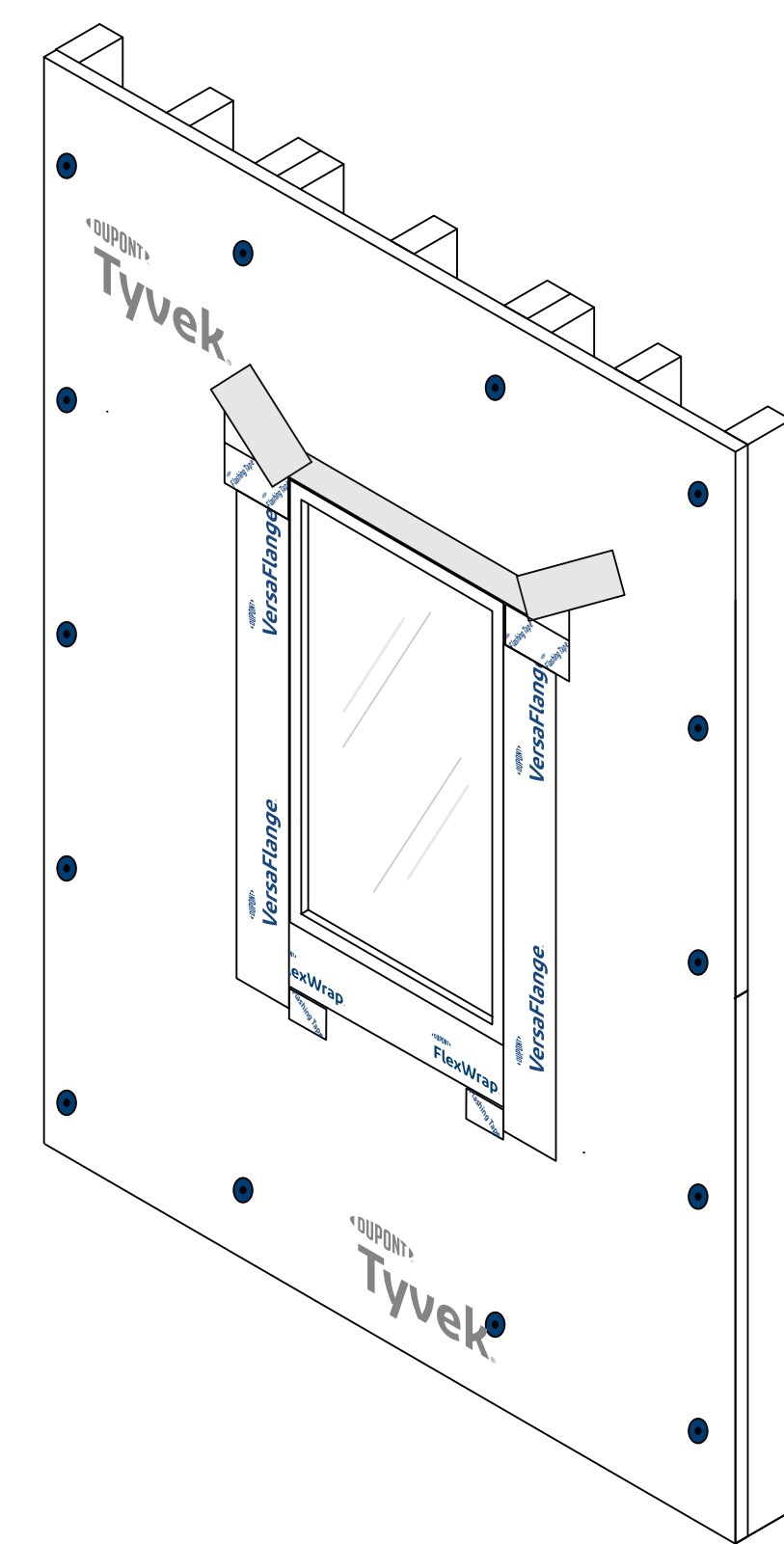

STEP 18

- A. CONTINUOUSLY SEAL THE HORIZONTAL AND DIAGONAL SEAMS OF THE TYVEK® WRB HEAD FLAP WITH DUPONT™ TYVEK® TAPE, DUPONT™ FLASHING TAPE OR DUPONT™ STRAIGHTFLASH™. INSTALL FASTENERS AS NEEDED THROUGH FLASHING FOR INCREASED HOLDING POWER.

SKIP SEALING WITH A MAXIMUM OF TWO (2) 2" GAPS FOR EVERY 3' OF WINDOW. IS ACCEPTABLE FOR ADDITIONAL DRAINAGE IF AN AIR BARRIER IS NOT REQUIRED.

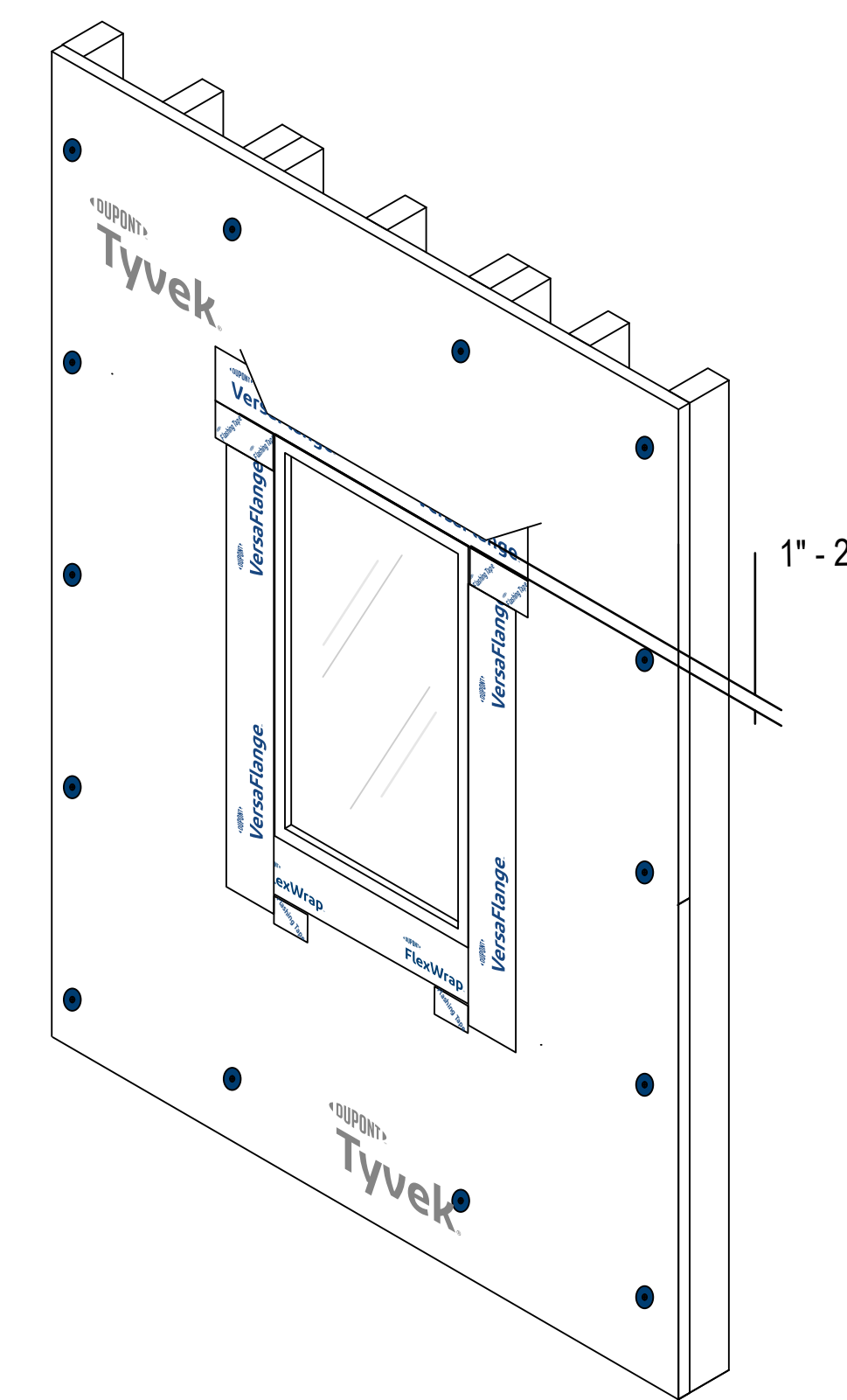
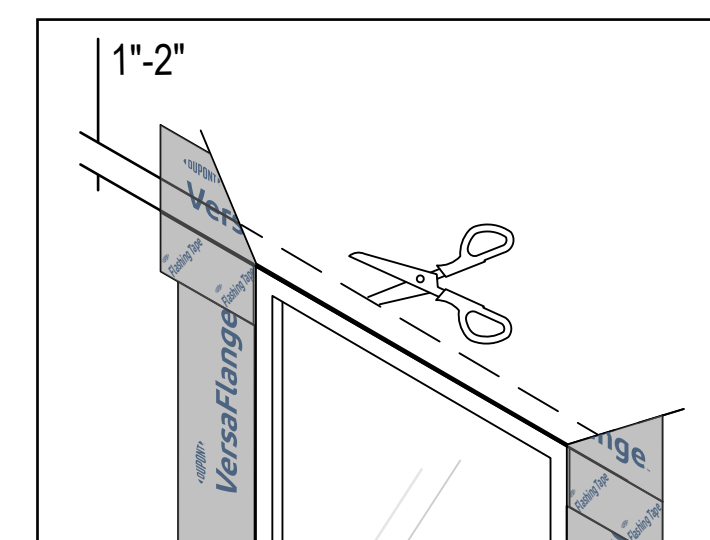

STEP 17

- A. TRIM THE TYVEK® WRB 1"-2" ABOVE THE WINDOW OPENING.
B. WHEN TRIMMING THE TYVEK® WRB, DO NOT CUT OR DAMAGE THE HEAD FLASHING THAT HAS BEEN INSTALLED BEHIND IT.

NOTES:
INSTALLATION IS APPLICABLE FOR SINGLE-FAMILY RESIDENTIAL & WOOD-FRAMED MULTI-FAMILY AND LIGHT COMMERCIAL BUILDINGS WHEN PERFORMANCE REQUIREMENTS DO NOT EXCEED ASTM E1677 (65 MPH EQUIVALENT STRUCTURAL LOAD AND 50 MPH (6.24 PSF) EQUIVALENT WIND-DRIVEN RAIN WATER INFILTRATION WHEN TESTED IN ACCORDANCE WITH ASTM E331, ASTM E1105, OR SIMILAR), AND WINDOW/DOOR DESIGN RATINGS THAT DO NOT EXCEED DP45. SEE *APPLICABLE STRUCTURES AND PERFORMANCE CRITERIA* IN THE APPLICABLE DUPONT INSTALLATION GUIDELINE FOR MORE INFORMATION REGARDING BUILDING TYPES AND BUILDING ENVELOPE PERFORMANCE.
ALWAYS CHECK [BUILDING.DUPONT.COM](https://building.dupont.com) FOR THE LATEST VERSIONS OF DUPONT INSTALLATION GUIDELINES AND OTHER PRODUCT LITERATURE.

Brick Mold Windows and Doors* Using DuPont™ VersaFlange™ Installed AFTER the DuPont™ Tyvek® WRB Installation Sequence

* Must have smooth frame for proper adhesion of VersaFlange™

DRAWING:
MF-OP-2310VF-MA
Page 3 of 3

REVISION DATE
1/20/2025
SCALE: Not to Scale

DUPONT
Tyvek