

STEP 8

- CUT TWO PIECES OF DUPONT™ FLASHING TAPE OR DUPONT™ STRAIGHTFLASH™ FOR JAMB FLASHING EXTENDING 1" ABOVE WINDOW HEAD FLANGE AND BELOW BOTTOM EDGE OF SILL FLASHING.
- REMOVE RELEASE PAPER AND PRESS TIGHTLY ALONG SIDES OF WINDOW FRAME.

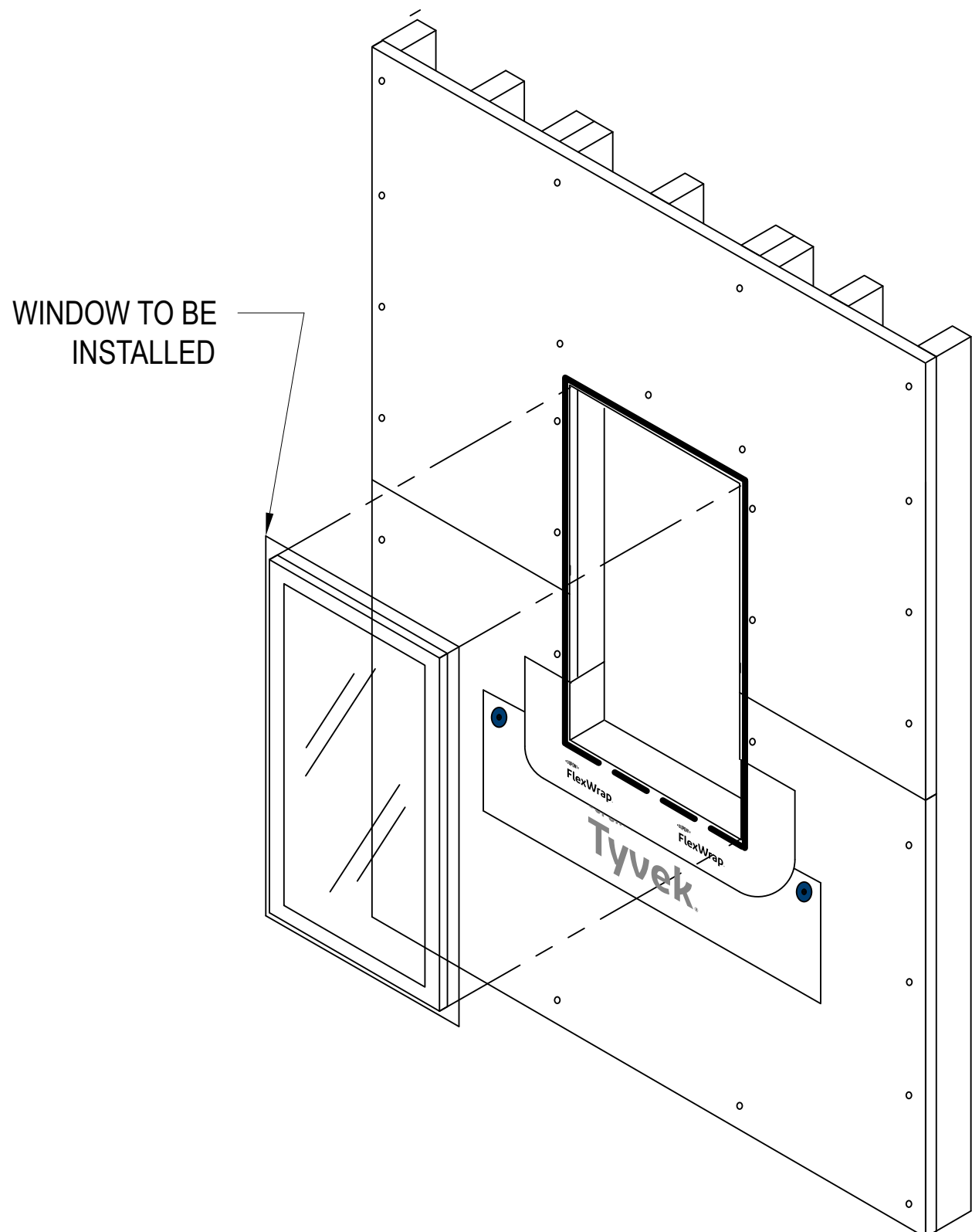

STEP 7

- INSTALL WINDOW ACCORDING TO MANUFACTURER'S INSTALLATION INSTRUCTIONS.

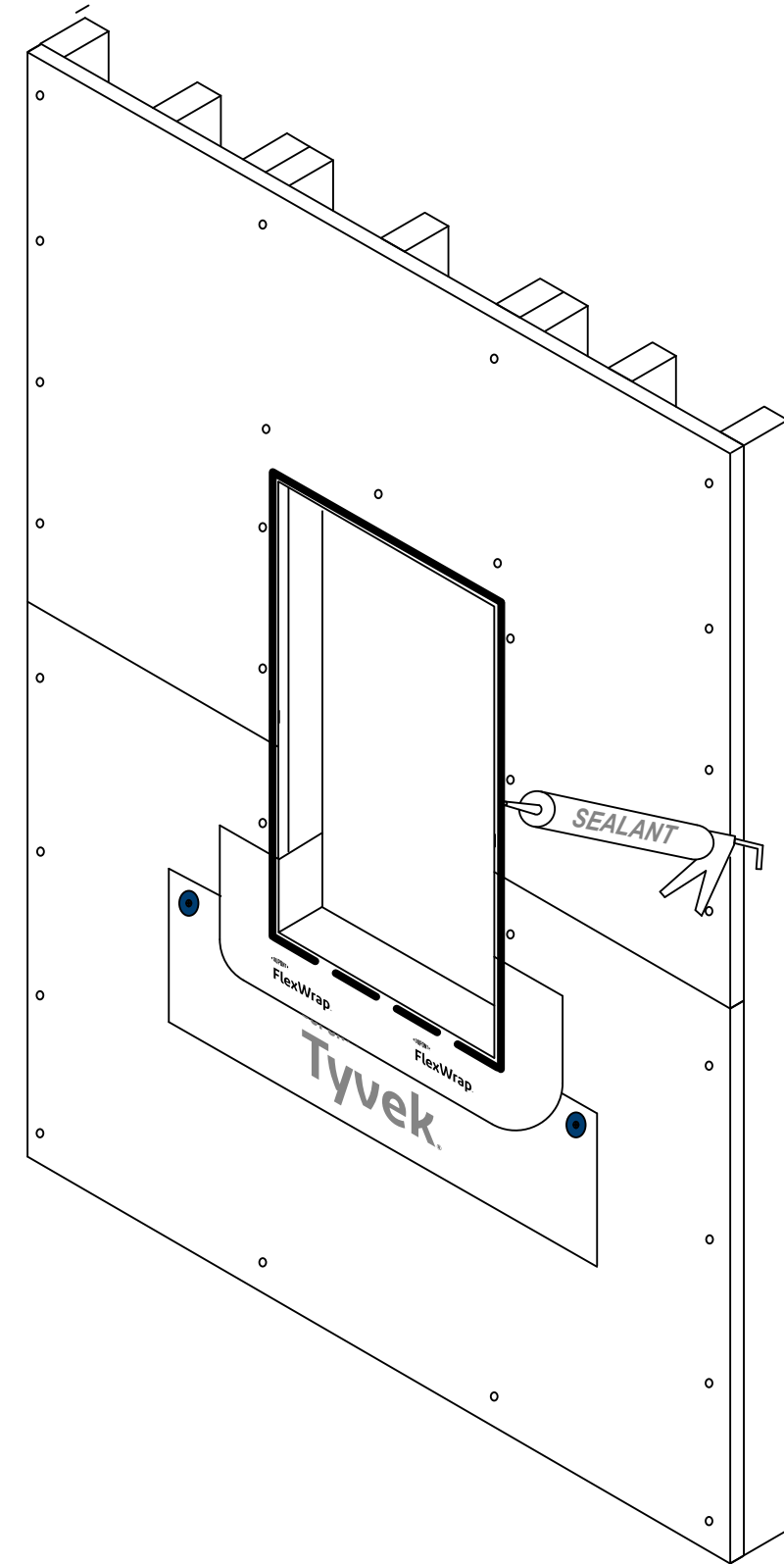

STEP 6

- APPLY A CHEMICALLY-COMPATIBLE SEALANT CONTINUOUSLY ON THE HEAD AND JAMBS OF ROUGH OPENING.
- IF SEALANT IS APPLIED TO THE SILL, ENSURE THAT THERE ARE AT LEAST TWO (2) 2" INCH GAPS IN THE SEALANT BEAD FOR EVERY 4' OF WINDOW TO ALLOW FOR DRAINAGE.

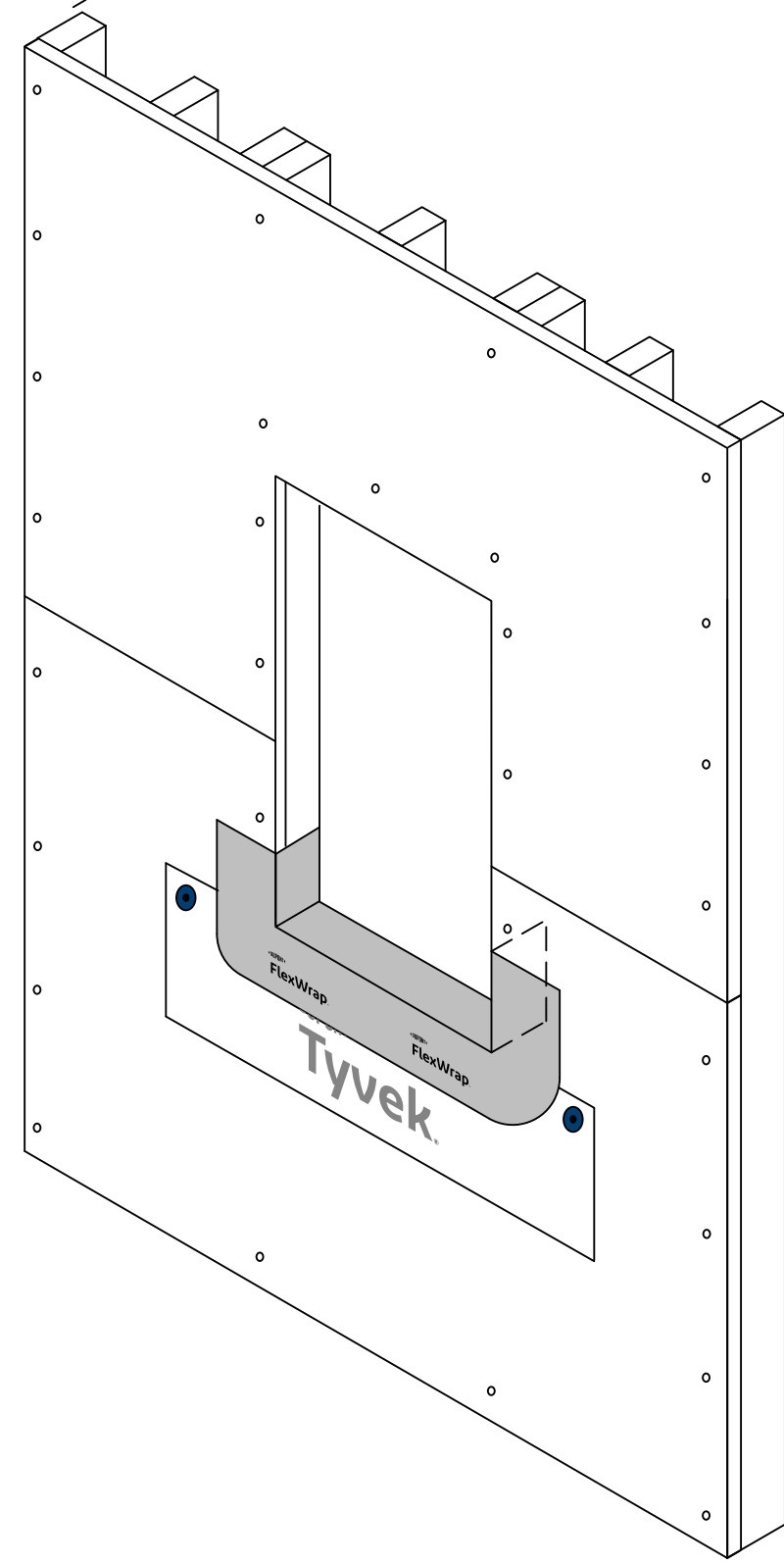

STEP 5

- REMOVE NARROW PIECE OF THE RELEASE PAPER.
- FAN DUPONT™ FLEXWRAP™ AT BOTTOM CORNERS AND ADHERE ONTO EXTERIOR FACE OF WALL. COVERAGE SHOULD BE 2"-3" ONTO THE FACE OF THE WALL.
- PRESS SILL FLASHING W/ FIRM HAND PRESSURE OR J-ROLLER TO ENSURE FULL ADHESION ON ALL SURFACES.

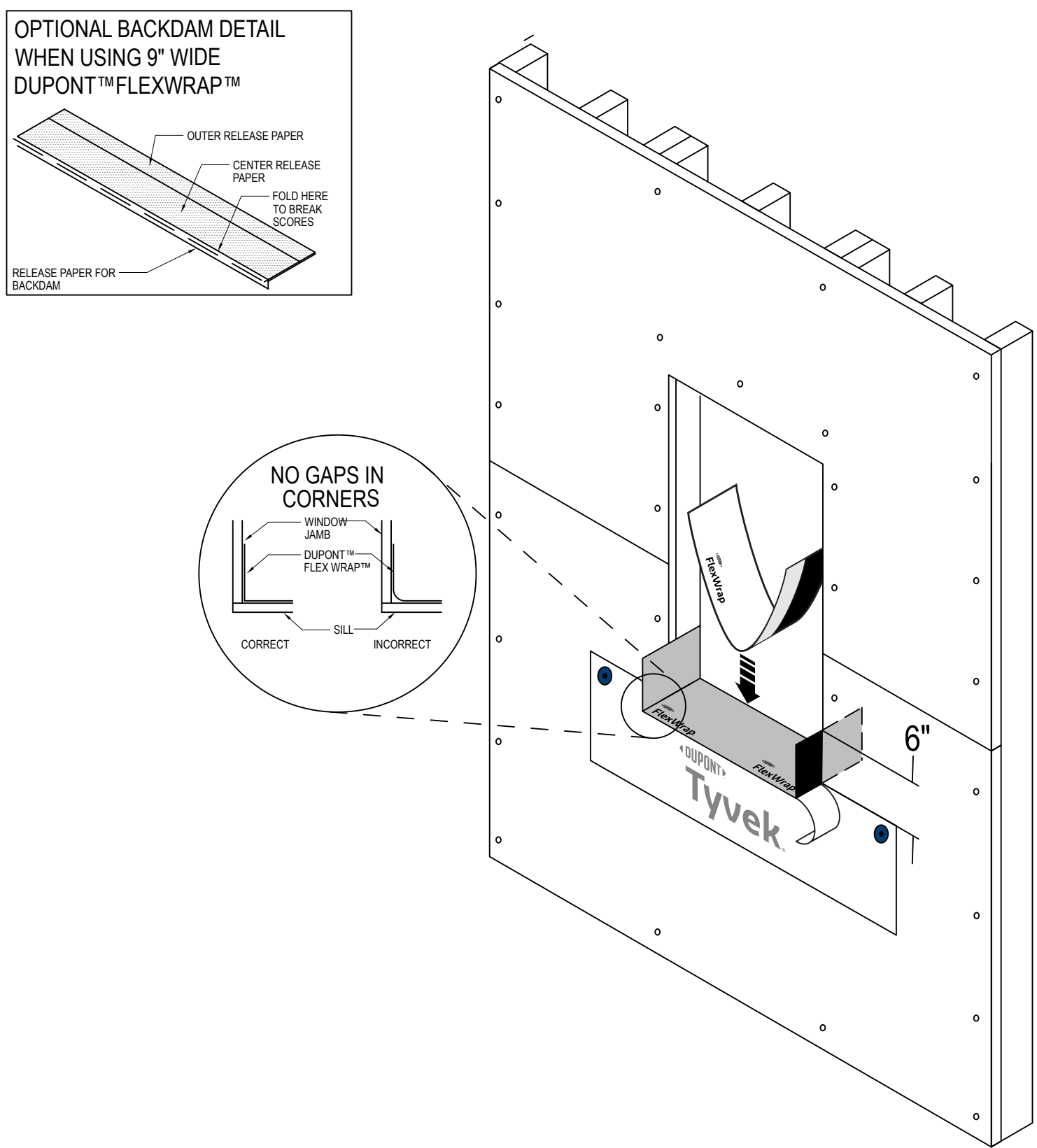

STEP 4

- REMOVE WIDE PIECE OF RELEASE PAPER. POSITION ON HORIZONTAL SILL BY ALIGNING THE INSIDE EDGE OF THE NARROW RELEASE PAPER WITH THE FACE OF THE WALL TO ENSURE 2"-3" OF THE FLEXWRAP™ WILL BE ADHERED TO THE FACE OF THE WALL WITH A MINIMUM OF 6" UP EACH JAMB.
- ADHERE INTO ROUGH OPENING. **DO NOT STRETCH** MATERIAL ALONG THE SILL OR JAMB.

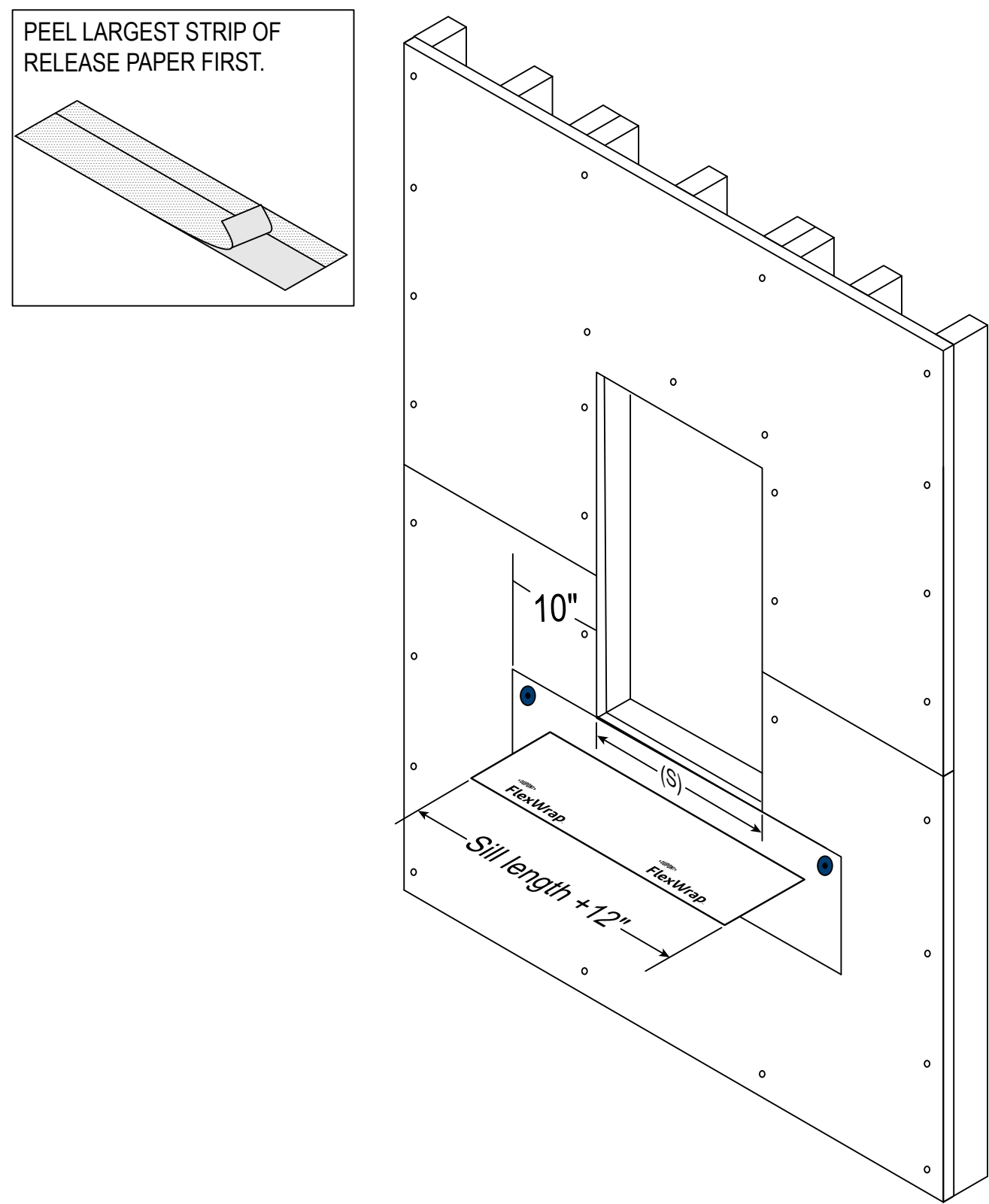

STEP 3

- PREPARE THE SILL FLASHING BY CUTTING A PIECE OF FLEXWRAP™ THAT IS AT LEAST 12" LONGER THAN THE WIDTH OF THE ROUGH OPENING SILL (S).
- USE 6" FLEXWRAP™ FOR 2"x 4" FRAMING AND 9" FLEXWRAP™ FOR 2"x 6" FRAMING.
- INSPECT INSTALLATION SURFACE TO ENSURE THE SURFACE IS FREE OF DIRT AND SUBSTANCES THAT COULD INTERFERE WITH ADHESION AS WELL AS ANY SHARP PROTRUSIONS.

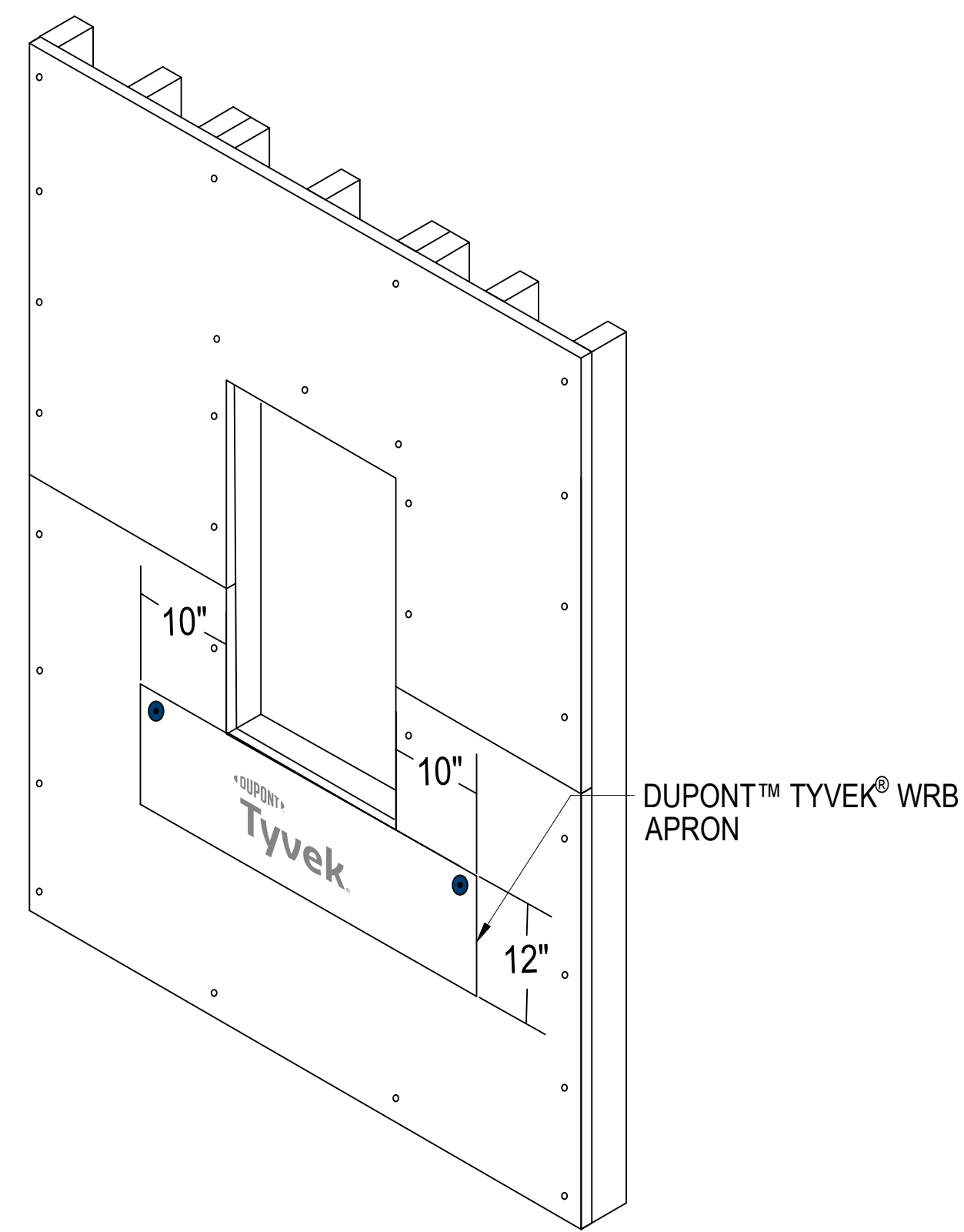

STEP 2

- PREPARE AN APRON MADE OF DUPONT™ TYVEK® WRB UNDER THE SILL OF ROUGH OPENING. APRON SHOULD EXTEND AT LEAST 10" BEYOND THE SIDES OF ROUGH OPENING JAMBS AND AT LEAST 12" BELOW THE SILL OF THE ROUGH OPENING.
- ATTACH THE TOP OF THE APRON TO THE WALL. LEAVE THE BOTTOM UNSECURED SO IT CAN OVERLAP THE TYVEK® WRB WHICH WILL BE INSTALLED AFTER THE WINDOW. AVOID PLACING DUPONT™ TYVEK® WRAP CAP FASTENERS OR RECOMMENDED FASTENERS WHERE DUPONT SELF-ADHERED FLASHING PRODUCTS WILL BE INSTALLED.

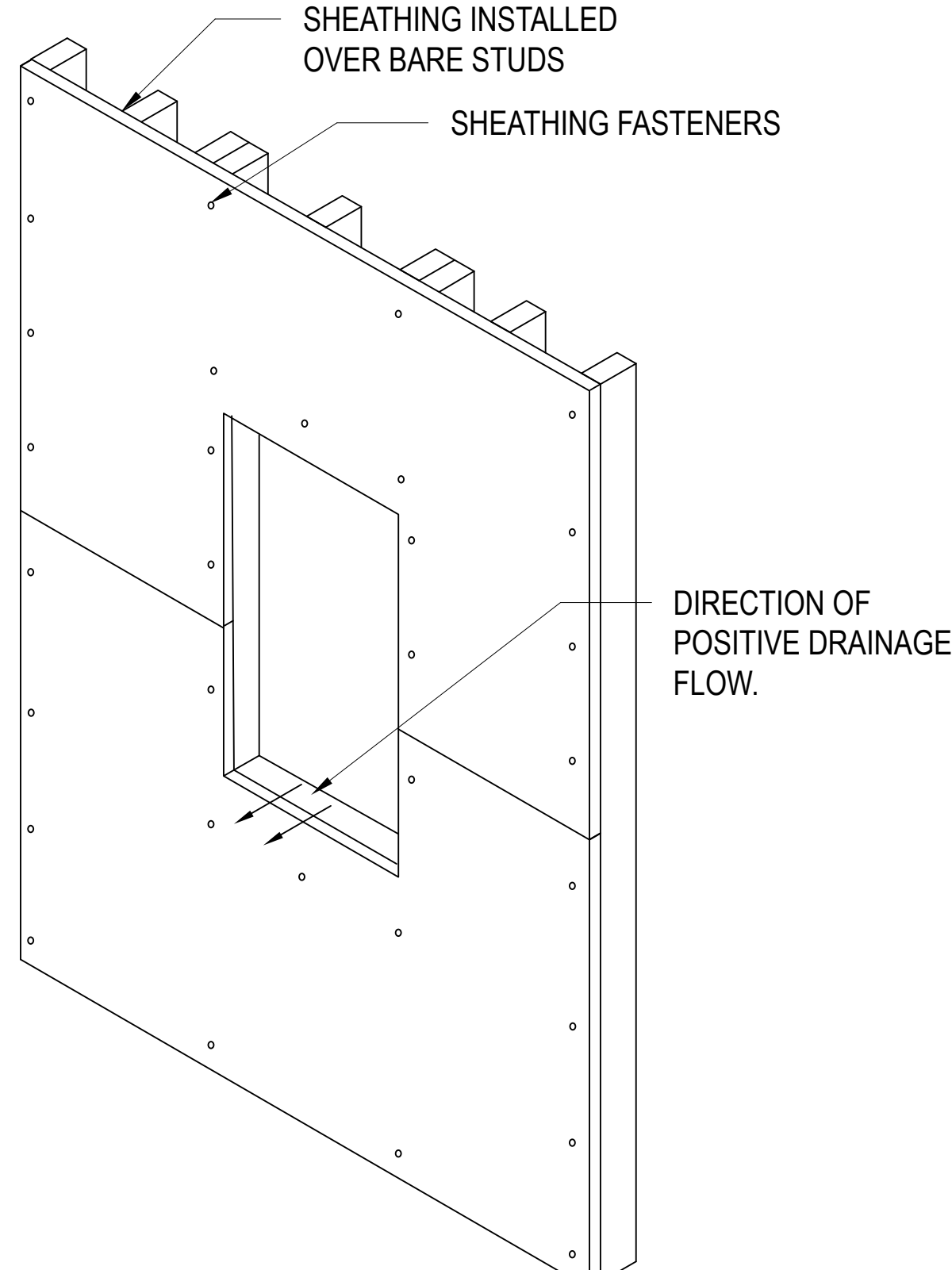

STEP 1

- SHEATHING TO BE INSTALLED OVER STUDS.
- AFTER SHEATHING HAS BEEN INSTALLED, CUT AN OPENING IN THE SHEATHING ALONG THE PERIMETER OF THE ROUGH OPENING FOR THE WINDOW.
- ENSURE THE SHEATHING IS CUT FLUSH WITH OR SLIGHTLY BELOW THE SILL FRAMING TO ALLOW FOR POSITIVE DRAINAGE.
- FRAMING IS ONLY SHOWN SCHEMATICALLY. SEE DRAWINGS BY OTHERS FOR DETAILED INFORMATION.

NOTES:
INSTALLATION IS APPLICABLE FOR SINGLE-FAMILY RESIDENTIAL & WOOD-FRAMED MULTIFAMILY AND LIGHT COMMERCIAL BUILDINGS WHEN PERFORMANCE REQUIREMENTS DO NOT EXCEED ASTM E1677 (65 MPH EQUIVALENT STRUCTURAL LOAD AND 50 MPH (6.24 PSF) EQUIVALENT WIND-DRIVEN RAIN WATER INFILTRATION WHEN TESTED IN ACCORDANCE WITH ASTM E331, ASTM E1105, OR SIMILAR), AND WINDOW/DOOR DESIGN RATINGS THAT DO NOT EXCEED DP45. SEE *APPLICABLE STRUCTURES AND PERFORMANCE CRITERIA* IN THE APPLICABLE DUPONT INSTALLATION GUIDELINE FOR MORE INFORMATION REGARDING BUILDING TYPES AND BUILDING ENVELOPE PERFORMANCE. ALWAYS CHECK [BUILDING.DUPONT.COM](https://building.dupont.com) FOR THE LATEST VERSIONS OF DUPONT INSTALLATION GUIDELINES AND OTHER PRODUCT LITERATURE.

Integral Flanged Window
Installed BEFORE the
DuPont™ Tyvek® WRB
Installation Sequence

DRAWING:
MF-OP-2120-MA
Page 1 of 2

REVISION DATE
1/20/2025
SCALE: Not to Scale

DUPONT
Tyvek

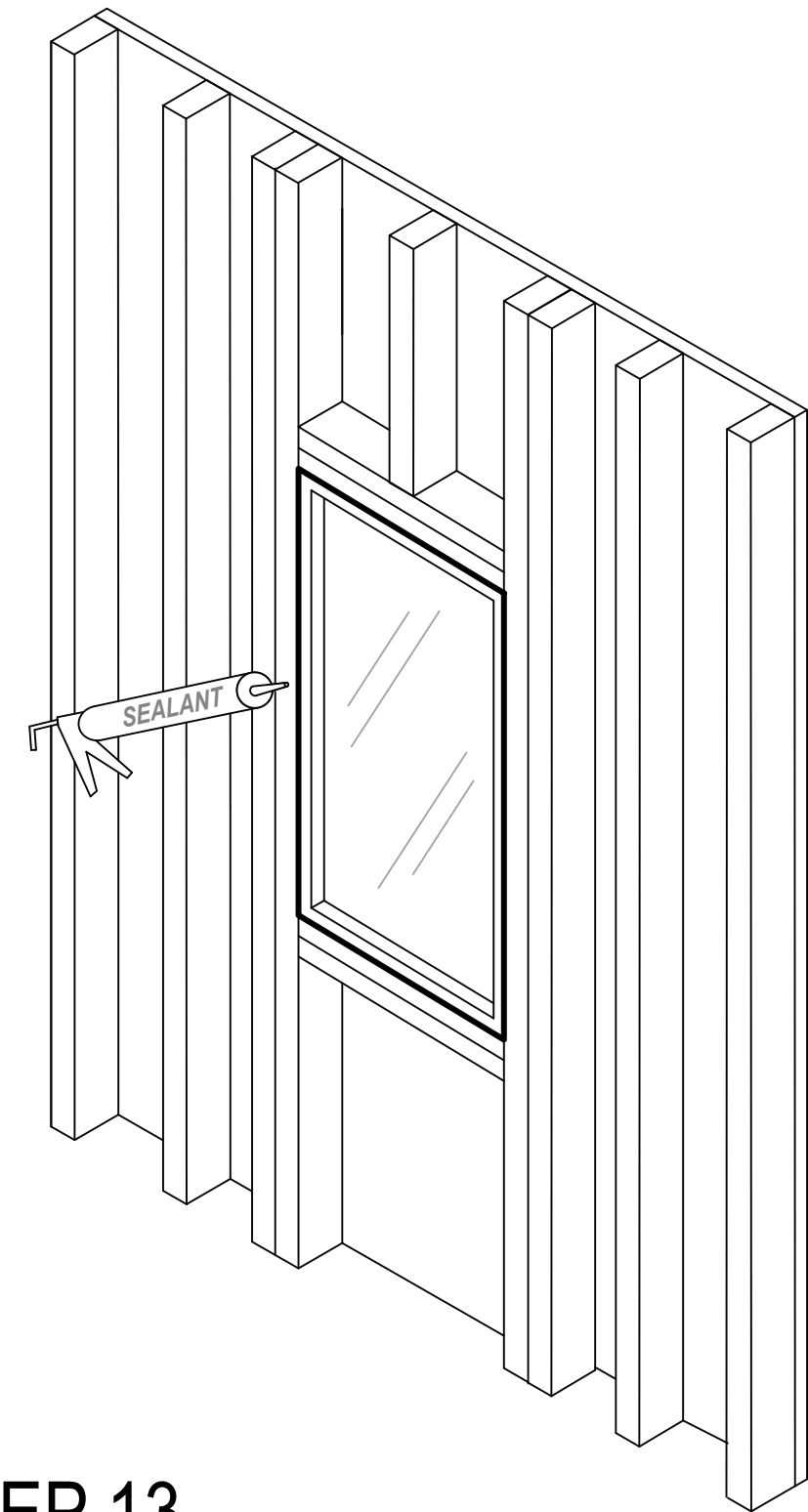

STEP 13

- A. APPLY A CHEMICALLY-COMPATIBLE SEALANT (AND BACKER ROD AS NECESSARY) AROUND THE WINDOW OPENING AT THE INTERIOR. IT IS ALSO ACCEPTABLE TO USE GREAT STUFF PRO™ WINDOW AND DOOR POLYURETHANE FOAM SEALANT OR A CHEMICALLY-COMPATIBLE FOAM.

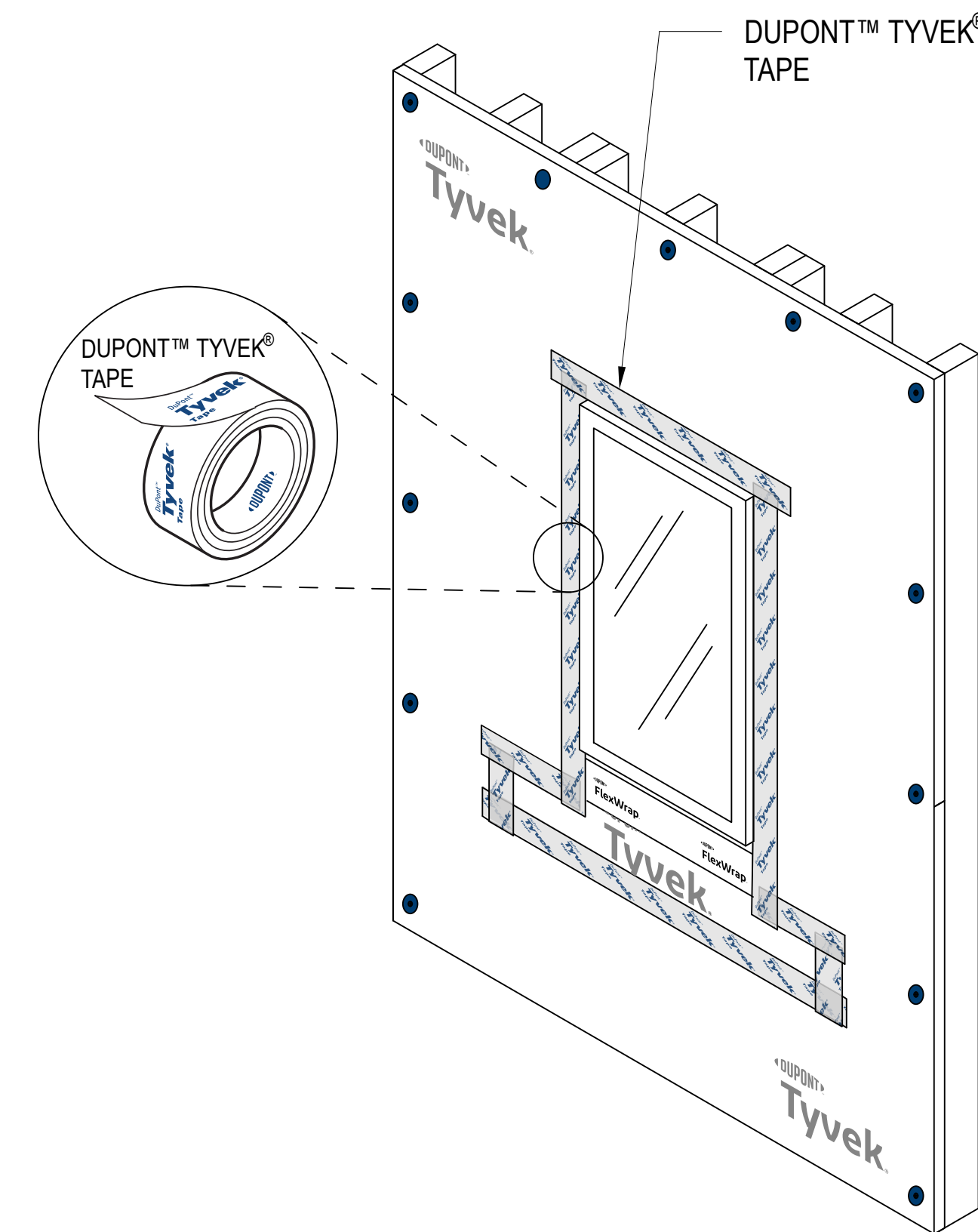

STEP 12

- A. BRING THE BOTTOM PORTION OF THE TYVEK® WRB APRON THROUGH THE SILL PERIMETER CUT AND HORIZONTAL SLITS SO IT LAPS OVER THE TOP LAYER OF THE TYVEK® WRB.
B. WORKING FROM BOTTOM TO TOP, SECURE HORIZONTAL AND VERTICAL SEAMS OF THE TYVEK® WRB APRON WITH DUPONT™ TYVEK® TAPE.
C. APPLY TYVEK® TAPE ALONG JAMBS AND HEAD TO SEAL THE TYVEK® WRB AROUND WINDOW. DUPONT™ FLASHING TAPE OR DUPONT™ STRAIGHTFLASH™ CAN BE USED FOR A MORE ROBUST TERMINATION.

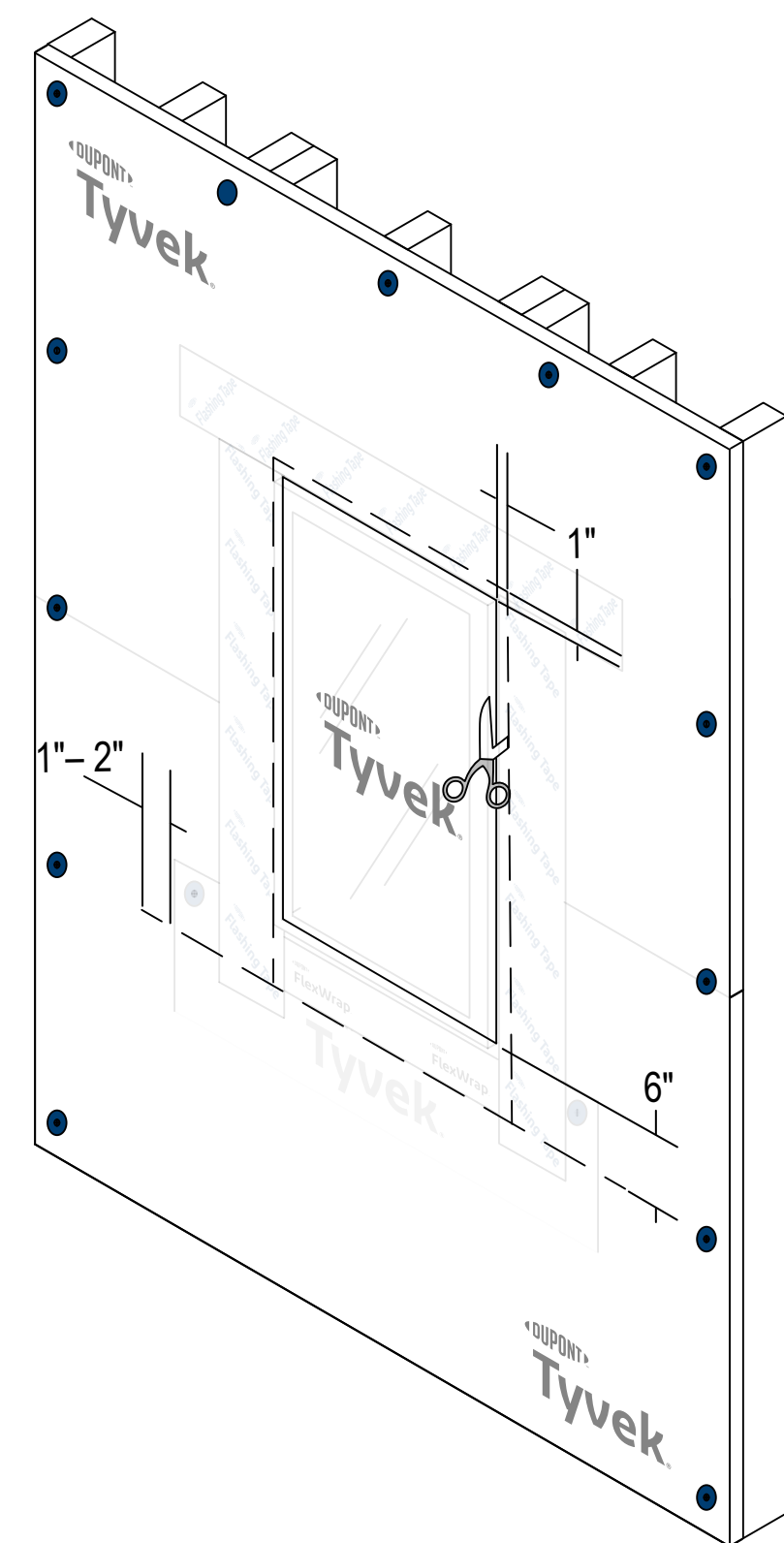

STEP 11

- A. MARK A PERIMETER ON THE TYVEK® WRB AROUND THE ROUGH OPENING A MINIMUM OF 1" FROM THE JAMBS AND HEAD OF THE WINDOW FRAME, AND 6" BELOW THE SILL OF THE WINDOW FRAME.
B. CUT THE TYVEK® WRB ALONG PERIMETER MARKING TO EXPOSE THE WINDOW. **DO NOT CUT** THROUGH THE FLASHING OR TYVEK® WRB APRON UNDERNEATH.
C. AT EACH LOWER CORNER OF THE PERIMETER CUT, MAKE HORIZONTAL SLITS IN THE TYVEK® WRB THAT EXTEND 1"– 2" **BEYOND** THE TYVEK® WRB APRON.

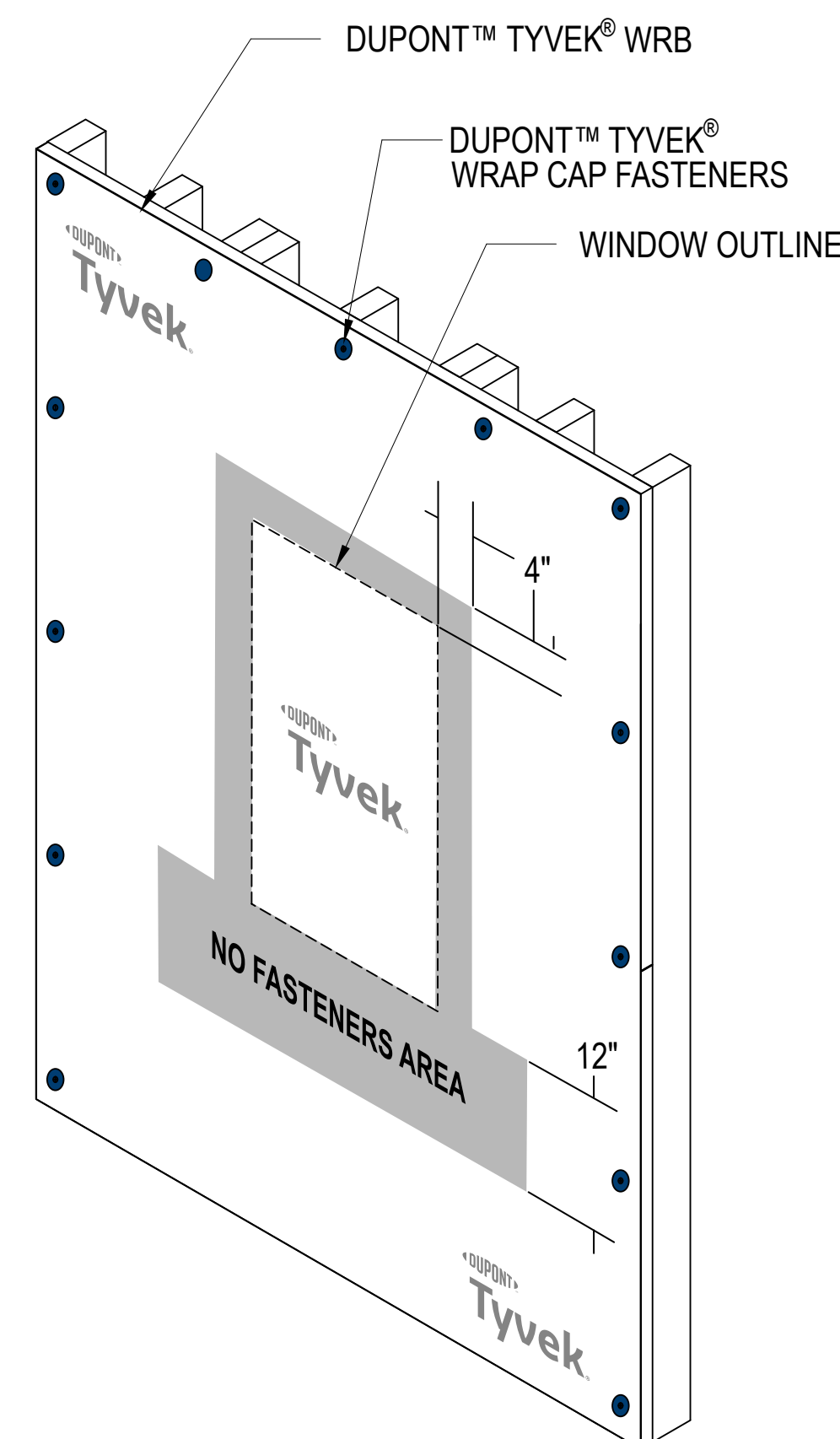

STEP 10

- A. DUPONT™ TYVEK® WRB TO BE MECHANICALLY FASTENED AND INSTALLED OVER SHEATHING.
B. **DO NOT INSTALL** FASTENERS WITHIN 4" OF THE WINDOW FRAME AT JAMBS AND HEAD AND WITHIN 12" OF THE WINDOW FRAME AT SILL OR LOCATION OF THE APRON.

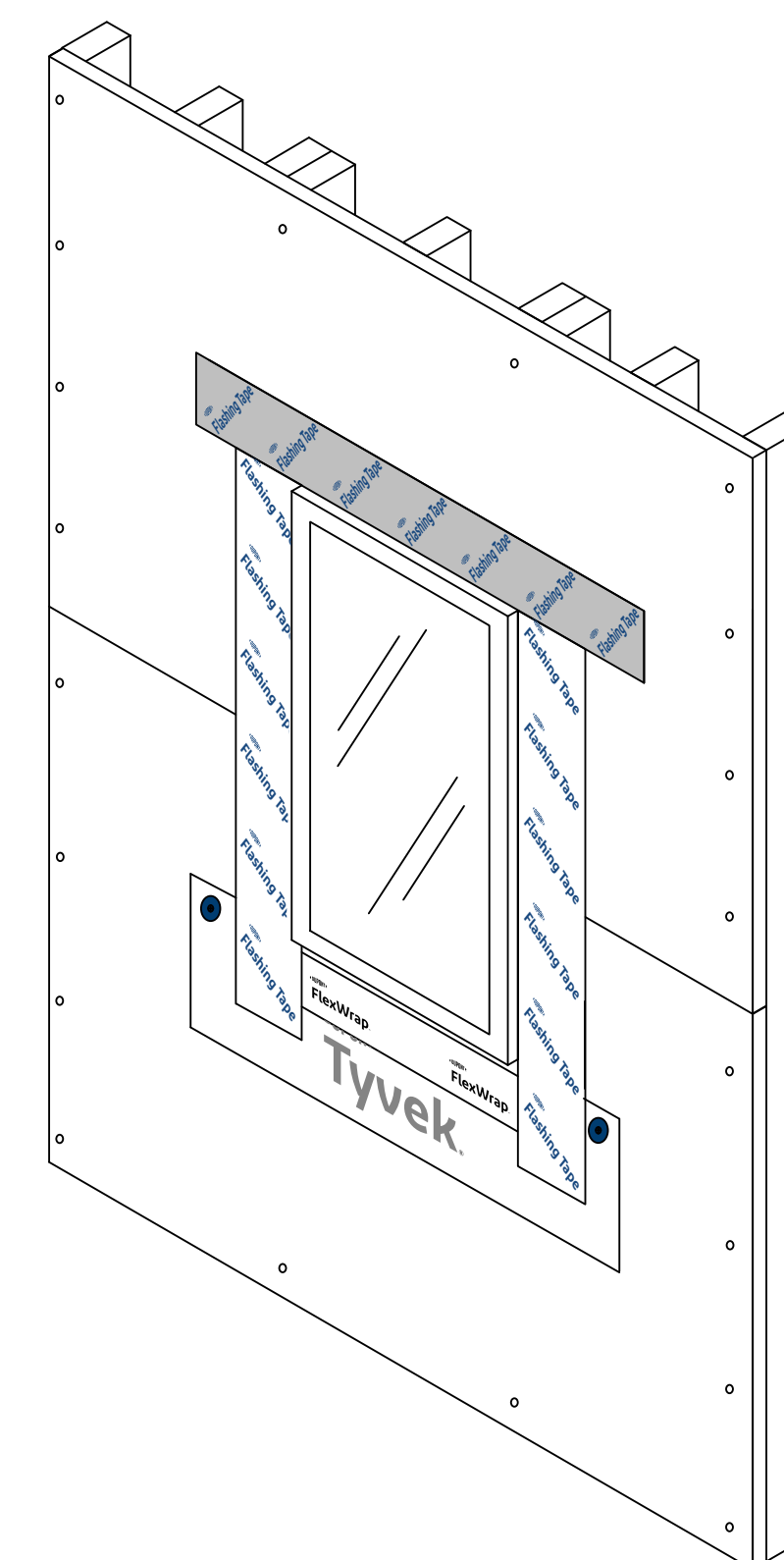

STEP 9

- A. CUT A PIECE OF DUPONT™ FLASHING TAPE OR STRAIGHTFLASH™ FOR HEAD FLASHING.
B. HEAD FLASHING TO EXTEND BEYOND OUTER EDGES OF JAMB FLASHING.
C. REMOVE RELEASE PAPER AND INSTALL COMPLETELY COVERING WINDOW MOUNTING FLANGE AND ADHERING TO THE EXPOSED SHEATHING.

NOTES:
INSTALLATION IS APPLICABLE FOR SINGLE-FAMILY RESIDENTIAL & WOOD-FRAMED MULITI-FAMILY AND LIGHT COMMERCIAL BUILDINGS WHEN PERFORMANCE REQUIREMENTS DO NOT EXCEED ASTM E1677 (65 MPH EQUIVALENT STRUCTURAL LOAD AND 50 MPH (6.24 PSF) EQUIVALENT WIND-DRIVEN RAIN WATER INFILTRATION WHEN TESTED IN ACCORDANCE WITH ASTM E331, ASTM E1105, OR SIMILAR); AND WINDOW/DOOR DESIGN RATINGS THAT DO NOT EXCEED DP45. SEE *APPLICABLE STRUCTURES AND PERFORMANCE CRITERIA* IN THE APPLICABLE DUPONT INSTALLATION GUIDELINE FOR MORE INFORMATION REGARDING BUILDING TYPES AND BUILDING ENVELOPE PERFORMANCE.
ALWAYS CHECK [BUILDING.DUPONT.COM](https://www.dupont.com/building) FOR THE LATEST VERSIONS OF DUPONT INSTALLATION GUIDELINES AND OTHER PRODUCT LITERATURE.

Integral Flanged Window
Installed **BEFORE** the
DuPont™ Tyvek® WRB
Installation Sequence

DRAWING: MF-OP-2120-MA Page 2 of 2	REVISION DATE: 1/20/2025
	SCALE: Not to Scale

